

NO.	QTY	DESCRIPTION	PART NO.
1	1	HOSE, 3 X 96 AIR DUCT	318625
2	6	NUT, HEX ES: .31-18	450578
3	2	CLAMP, HOSE: 2.81-3.75 DIA	460086
4	1	ADAPTER, AIR OUTLET	468475
5	3	CLAMP, HOSE: 3.5 DIA	473399
6	3	SCR, HEX FLG: .31-18 X 1	491043
7	3	SCR, HEX FLG: .31-18 X .75	491045
8	6	WASHER, FENDER: .31	491433
9	3	SCR, SEL TPG: .25 X .75	491702
10	1	WIRE HARNESS, CONN 025/025	718721

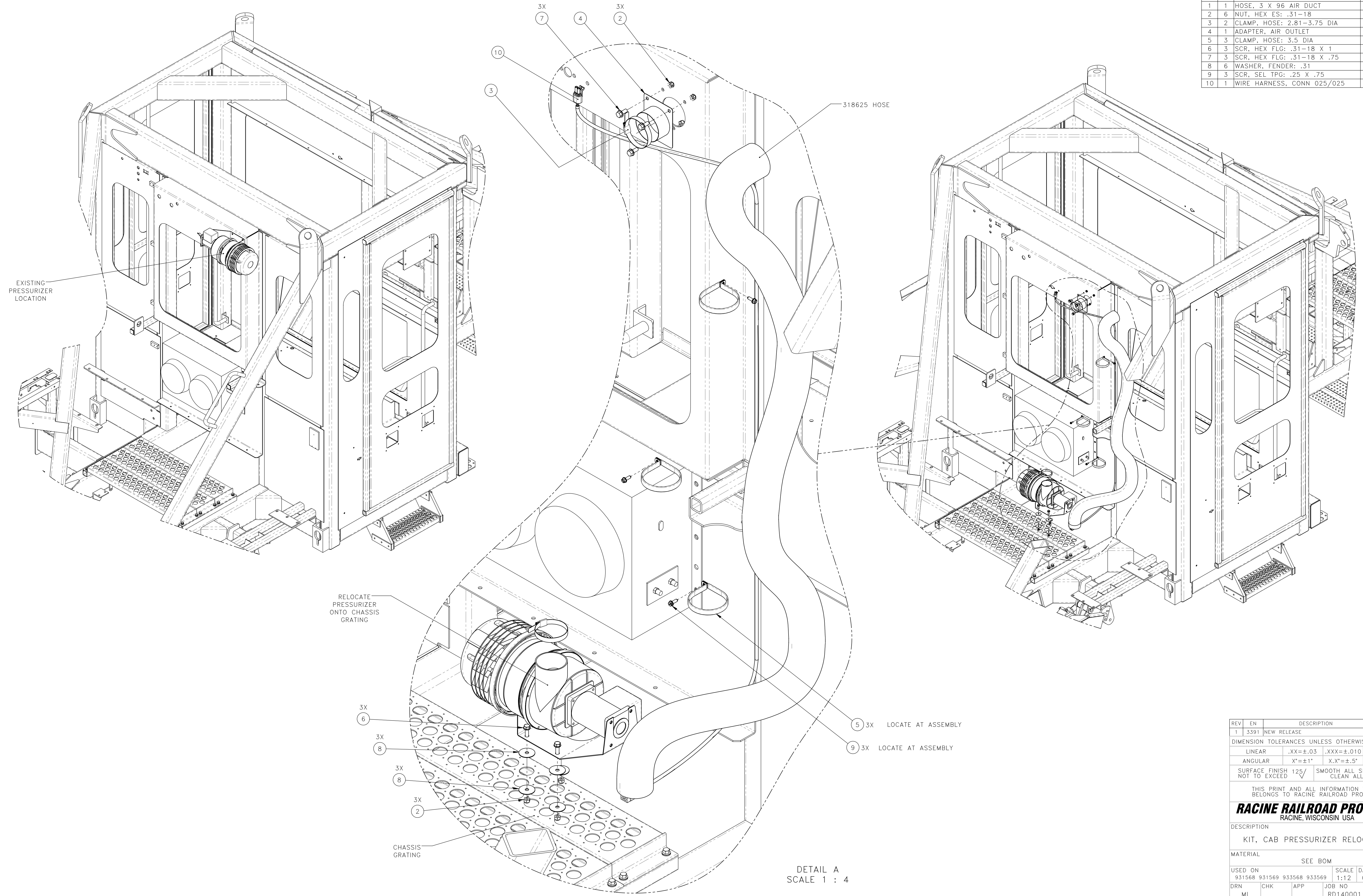

DETAIL A
SCALE 1 : 4

REV	EN	DESCRIPTION	DATE	DRN
1		3391 NEW RELEASE	8-18	MAI

DIMENSION TOLERANCES UNLESS OTHERWISE SPECIFIED

LINEAR	.XX=±.03	.XXX=±.010
ANGULAR	X' = ±1'	X.X' = ±.5'

SURFACE FINISH 125/ SMOOTH ALL SHARP EDGES
NOT TO EXCEED CLEAN ALL WELDS

THIS PRINT AND ALL INFORMATION WITHIN
BELONGS TO RACINE RAILROAD PRODUCTS

RACINE RAILROAD PRODUCTS
RACINE, WISCONSIN USA

DESCRIPTION
KIT, CAB PRESSURIZER RELOCATION

MATERIAL
SEE BOM

USED ON	SCALE	DATE
931568 931569 933568 933569	1:12	08-06-18

DRN	CHK	APP	JOB NO	SHEET
MI			RD140001	1 OF 1
EXP NO			DWG NO	