

INSTALLATION INSTRUCTIONS:

1. REMOVE D03 VALVE AND O-RINGS, DISCARD EXISTING SCREWS.
2. POSITION D03 TAPPING PLATE MAKING SURE THAT ORIFICE PLUG IS INSTALLED ON P PORT HOLE AND O-RINGS SUPPLIED WITH TAPPING PLATE ARE IN POSITION (NOTE ORIENTATION OF TAPPING PLATE PIN).
3. REINSTALL D03 VALVE USING AND O-RINGS WITH SUPPLIED SCREWS, TORQUE TO 44-62 IN/LB.
4. REPEAT ABOVE STEPS FOR REMAINING PROPEL SECTION.

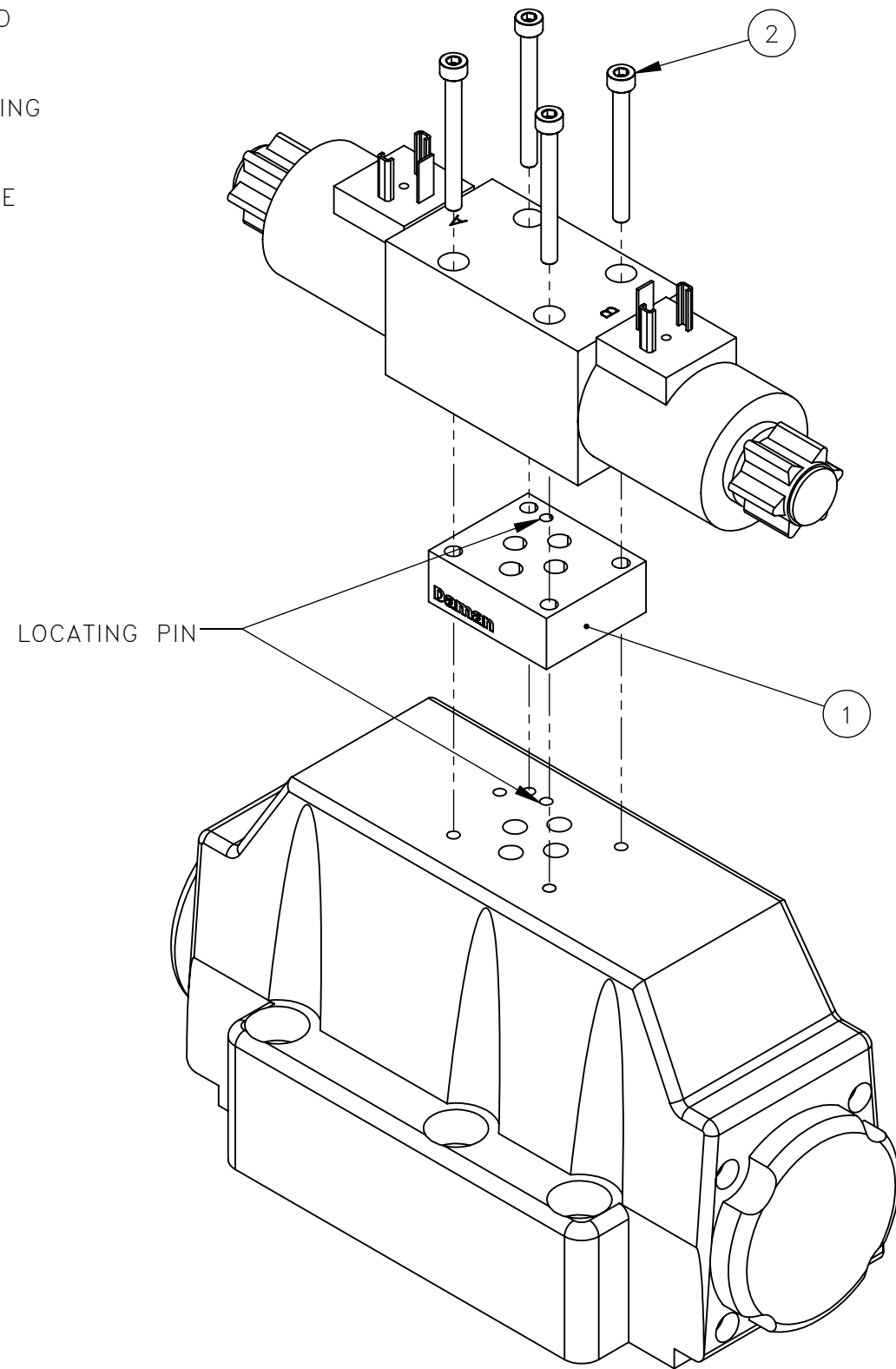

NO.	QTY	DESCRIPTION	PART NO.
1	REF	PLATE, D03 TAPPING	319089
2	REF	SCR, SOC: M5-0.8 X 50	501191

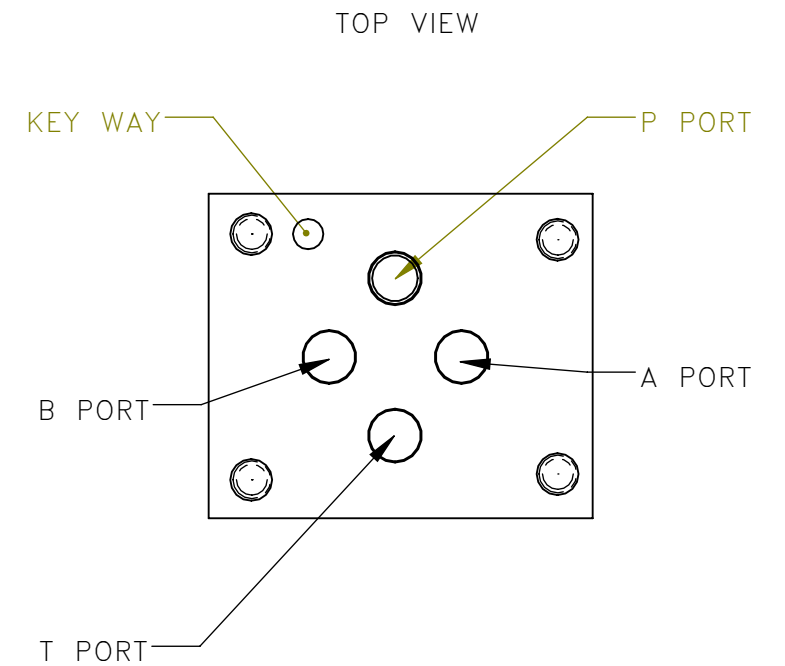

REV	EN	DESCRIPTION	DATE	DRN
1	3153	NEW RELEASE	5-18	PJP
2	3280	DEL 473513 318839, ADD 319089	7-18	PJP

DIMENSION TOLERANCES UNLESS OTHERWISE SPECIFIED

LINEAR	.XX=±.03	.XXX=±.010
ANGULAR	X°=±1°	X.X°=±.5°

SURFACE FINISH 125/✓ NOT TO EXCEED
SMOOTH ALL SHARP EDGES
CLEAN ALL WELDS

THIS PRINT AND ALL INFORMATION WITHIN BELONGS TO RACINE RAILROAD PRODUCTS

RACINE RAILROAD PRODUCTS
RACINE, WISCONSIN USA

DESCRIPTION
INSTRUCTIONS, PROPEL SOFT START

MATERIAL
SEE BOM

USED ON	793024	SCALE	1:4	DATE	05-14-18
---------	--------	-------	-----	------	----------

DRN	CHK	APP	JOB NO	SHEET	1 OF 1
PP					

EXP NO	DWG NO	800284
--------	--------	--------