

REMOVAL INSTRUCTIONS:

CLOSE HYDRAULIC OIL RESERVOIR VALVE AND DISCONNECT ELECTRICAL WIRING TO EACH VALVE.

- 1 USING PROPER OIL CONTAINMENT PROCEDURES, CAREFULLY REMOVE PORT RELIEF PLUG, HELICAL SPRING, AND RELIEF CARTRIDGE FROM CENTER INSERT VALVE SECTION, PORT "A". ALLOW HYDRAULIC OIL TO DRAIN.
- 2 DISCARD EXISTING O-RING, HELICAL SPRING AND RELIEF CARTRIDGE.

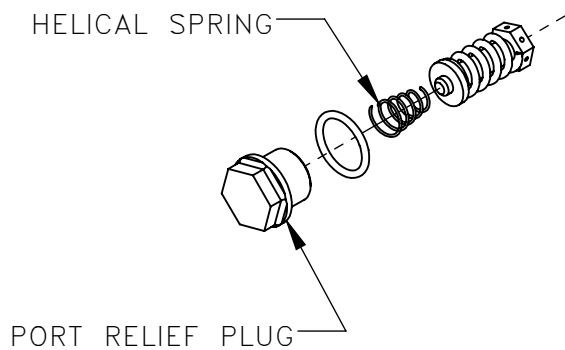
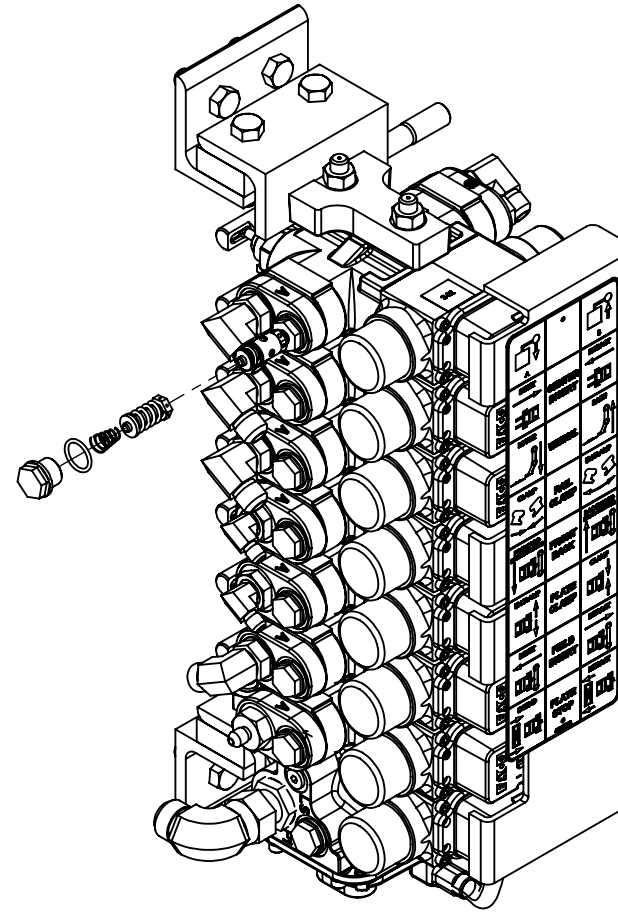
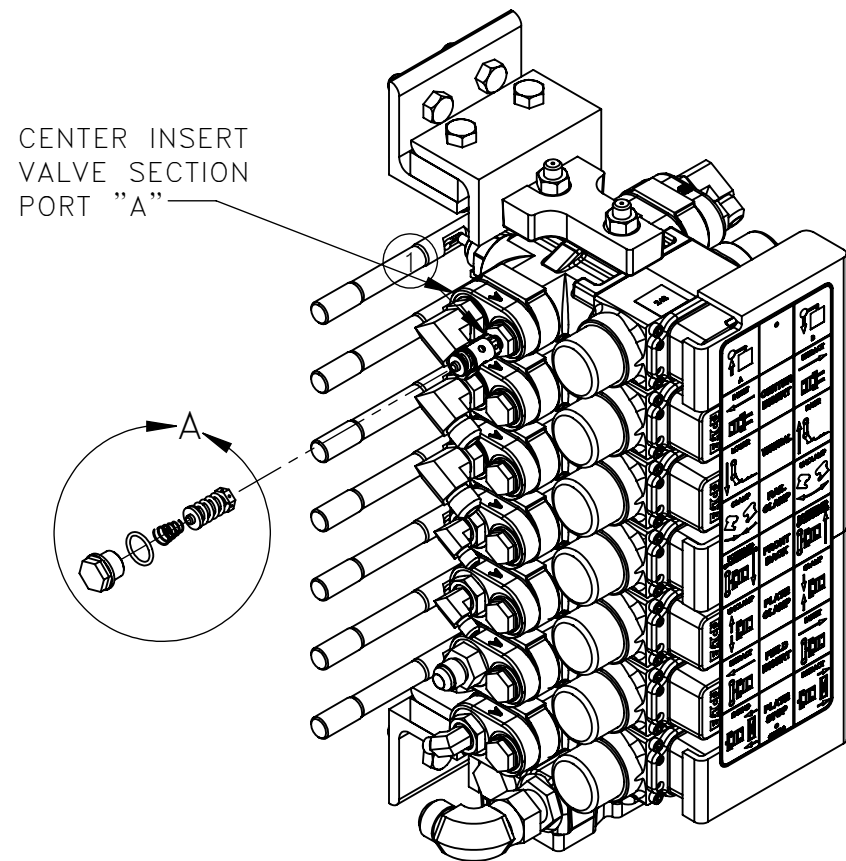

DETAIL A
SCALE 2 : 5

NO.	QTY	DESCRIPTION	PART NO.
1	REF	CARTRIDGE, RELIEF VALVE	473924
2	REF	O-RING, .755 ID X .097 W	473949

REV	EN	DESCRIPTION	DATE	DRN
1	3686	NEW RELEASE	11-18	MSO
DIMENSION TOLERANCES UNLESS OTHERWISE SPECIFIED				
LINEAR		.XX=±.03	.XXX=±.010	
ANGULAR		X°=±1°	X.X°=±.5°	
SURFACE FINISH		125/√	SMOOTH ALL SHARP EDGES CLEAN ALL WELDS	
THIS PRINT AND ALL INFORMATION WITHIN BELONGS TO RACINE RAILROAD PRODUCTS				
RACINE RAILROAD PRODUCTS RACINE, WISCONSIN USA				
DESCRIPTION INSTRUCTIONS, PORT RELIEF CARTRIDGE				
MATERIAL SEE BOM				
USED ON		793041	SCALE 1:5	DATE 11-05-18
DRN MSO	CHK	APP	JOB NO RD150003	SHEET 1 OF 2
EXP NO			DWG NO 800303	

INSTALLATION INSTRUCTIONS:

- 1 CAREFULLY INSERT SUPPLIED RELIEF VALVE CARTRIDGE,
DO NOT DISTURB THE SETTING OF THE RELIEF VALVE. MAKE SURE
VALVE IS SEATED PROPERLY IN THE CAVITY.
- 2 INSTALL O-RINGS ONTO PLUGS, INSTALL PLUGS.
- 3 RECONNECT ELECTRICAL WIRING.

AFTER ALL PLUGS ARE SEALED, OPEN HYDRAULIC OIL RESERVOIR VALVE.

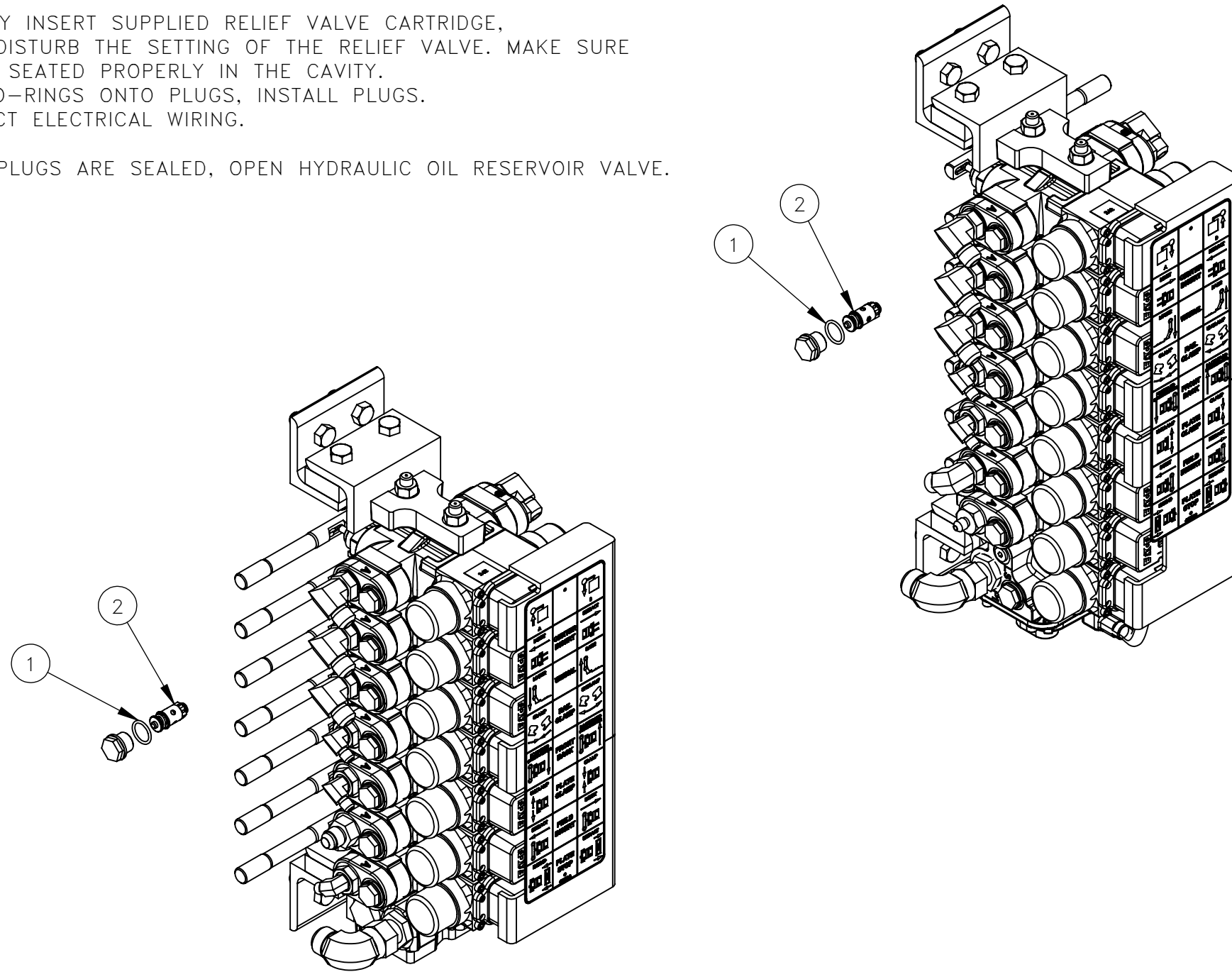

REV	EN	DESCRIPTION	DATE	DRN
1	3686	NEW RELEASE	11-18	MSO
DIMENSION TOLERANCES UNLESS OTHERWISE SPECIFIED				
LINEAR		.XX=±.03	.XXX=±.010	
ANGULAR		X°=±1°	X.X°=±.5°	
SURFACE FINISH NOT TO EXCEED		125/√	SMOOTH ALL SHARP EDGES CLEAN ALL WELDS	
THIS PRINT AND ALL INFORMATION WITHIN BELONGS TO RACINE RAILROAD PRODUCTS				
RACINE RAILROAD PRODUCTS RACINE, WISCONSIN USA				
DESCRIPTION				
INSTRUCTIONS, PORT RELIEF CARTRIDGE				
MATERIAL				
SEE BOM				
USED ON		793041	SCALE	DATE
			1:5	11-05-18
DRN	CHK	APP	JOB NO	SHEET
MSO			RD150003	2 OF 2
EXP NO			DWG NO	
			800303	