

NO.	QTY.	DESCRIPTION	PART NO.
1	REF	ADAPTER, .25 NPT(F) X M18(M)	321975
2	1	O-RING, .644 ID X .087 W	407139
3	REF	CABLE, MICRO: 4 PIN(F) 90° X 4 PIN DEUTSCH 3 M	473024
4	REF	TRANSDUCER, PRESSURE	475566
5	REF	PLACARD, DB-4	475568

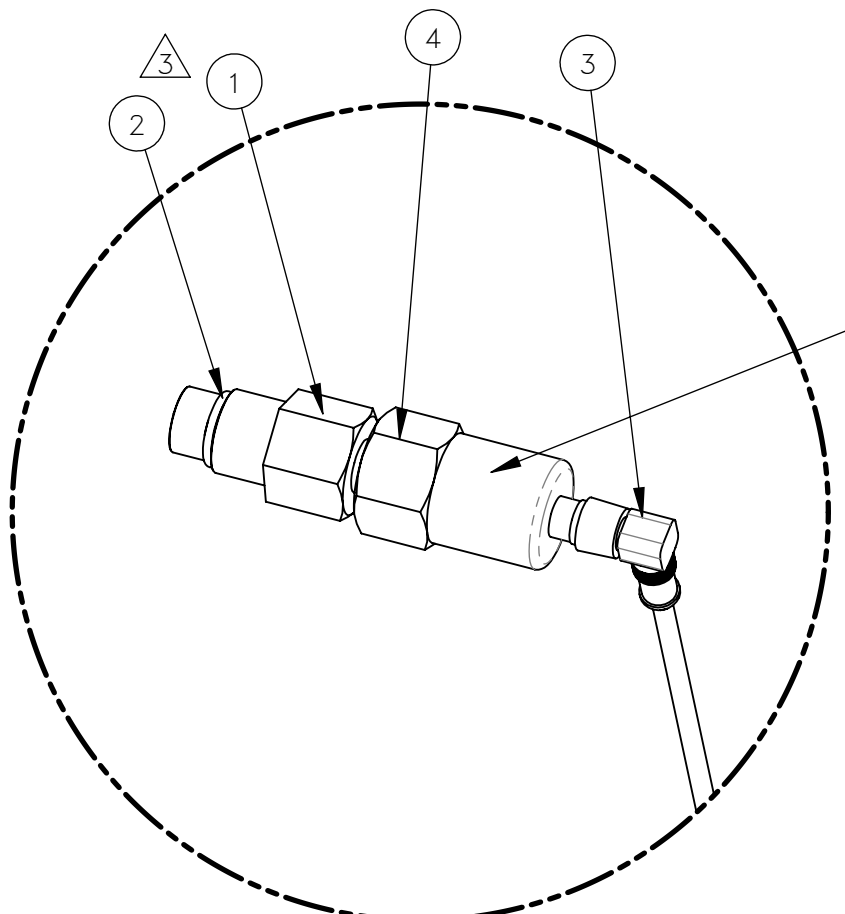

DETAIL A
SCALE 1 : 2

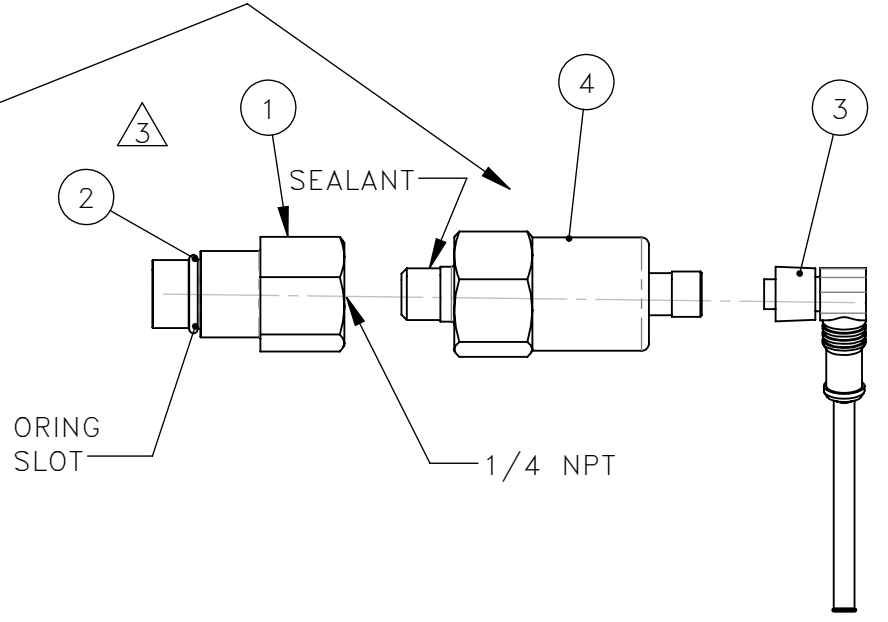

INSTRUCTIONS FOR KIT 793096:

INSIDE THE ENCLOSURE OF THE CUMMIN'S QFS3.8 ENGINE THERE IS AN OIL COOLER ASSEMBLY. REMOVE THE A M18X1.5 STRAIGHT PLUG (SHOWN IN FIG 1-1 CIRCLED IN RED).

LOCATED AT THE REAR UP THE FRAME STRUT. REMOVE DISTRIBUTION BOX 4 AND THE PLACARD DB-4. KEEP FASTENERS FOR REUSE (SEE DETAIL B).

INSTALLATION:

1. ASSEMBLE ORING ITEM 2 TO THE MALE THREADED END OF ADAPTER ITEM 1 PLACE INTO SLOT BETWEEN THE THREAD AND BACK (SEE DETAIL A).
2. SECURE ADAPTER ITEM 1 TO OIL COOLER ASSEMBLY (SEE DETAIL A).
2. INSTALL THE TRANSDUCER ITEM 4 TO ADAPTER ITEM 2 WITH THREAD SEALANT (SEE DETAIL A).
3. ATTACH 4PIN (F) CABLE END ITEM 3 TO THE TRANSDUCER ITEM 4.
4. REPLACE THE PLACARD WITH THE NEW PLACARD ITEM 5 (SHOWN IN FIG. 1-2).
5. REATTACHED THE DISTRIBUTION BOX 4 WITH THE NEW PLACARD ITEM 5 TO THE REAR UP THE FRAME STRUT. REUSING THE SAVED FASTENERS(SEE DETAIL B).
6. ROUTE ITEM 3 CABLE 4PIN (M) END UP THE REAR OF THE FRAME STRUT DISTRIBUTION BOX 4 AND PLUG INTO PORT 2(SEE DETAIL B).

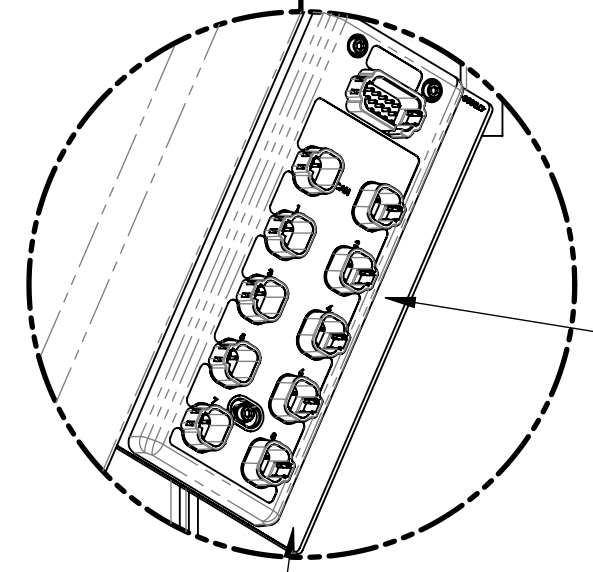

DETAIL B
SCALE 1 : 4

ROUTE TO
DB-4
PORT 2
CONN 125

TURNABLE PLANCH LAMP 1691 CONN 137	TURNABLE LATCHED LIMIT SWITCH 1692 CONN 135
CLSE DOWN FILTER SWITCH 135 CONN 135	RETURN FILTER SVC SENSOR 131 CONN 131
PRESSURE FILTER SWITCH 129 CONN 129	HYD RESERVOIR TEMP & LEVEL 127 CONN 127
ENG. OIL PRESSURE 125 CONN 125	CONN 123
CONN 122	CAN CONN 121
DB-4	PWR&CFG CONN 120

DETAIL C
SCALE 1 : 1

ENG. OIL
PRESSURE
CONN 125

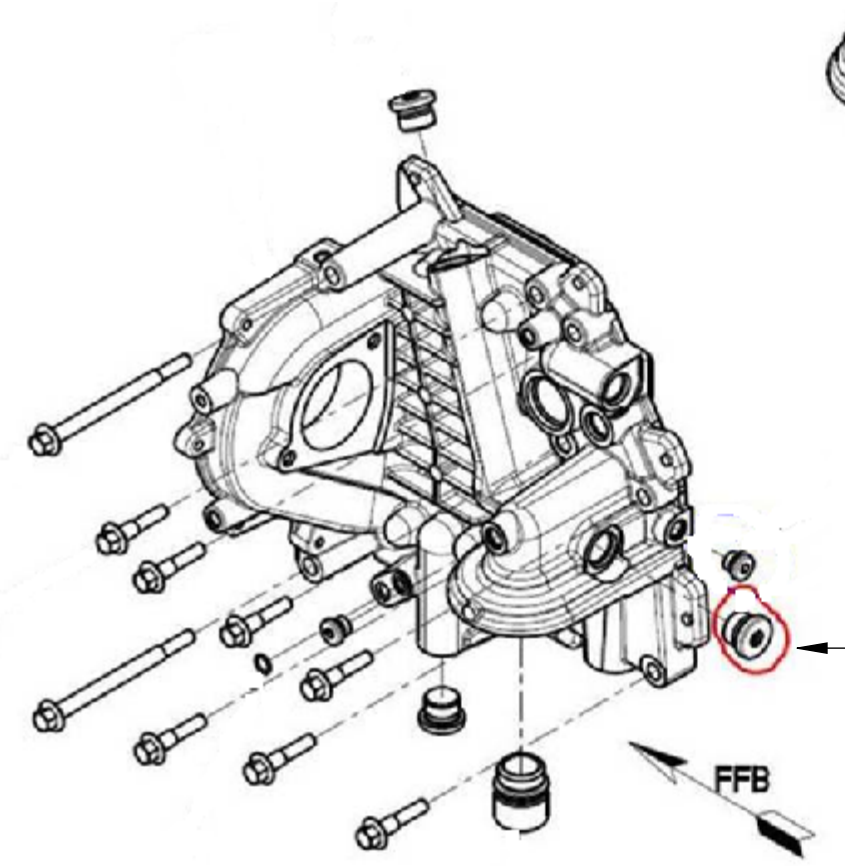
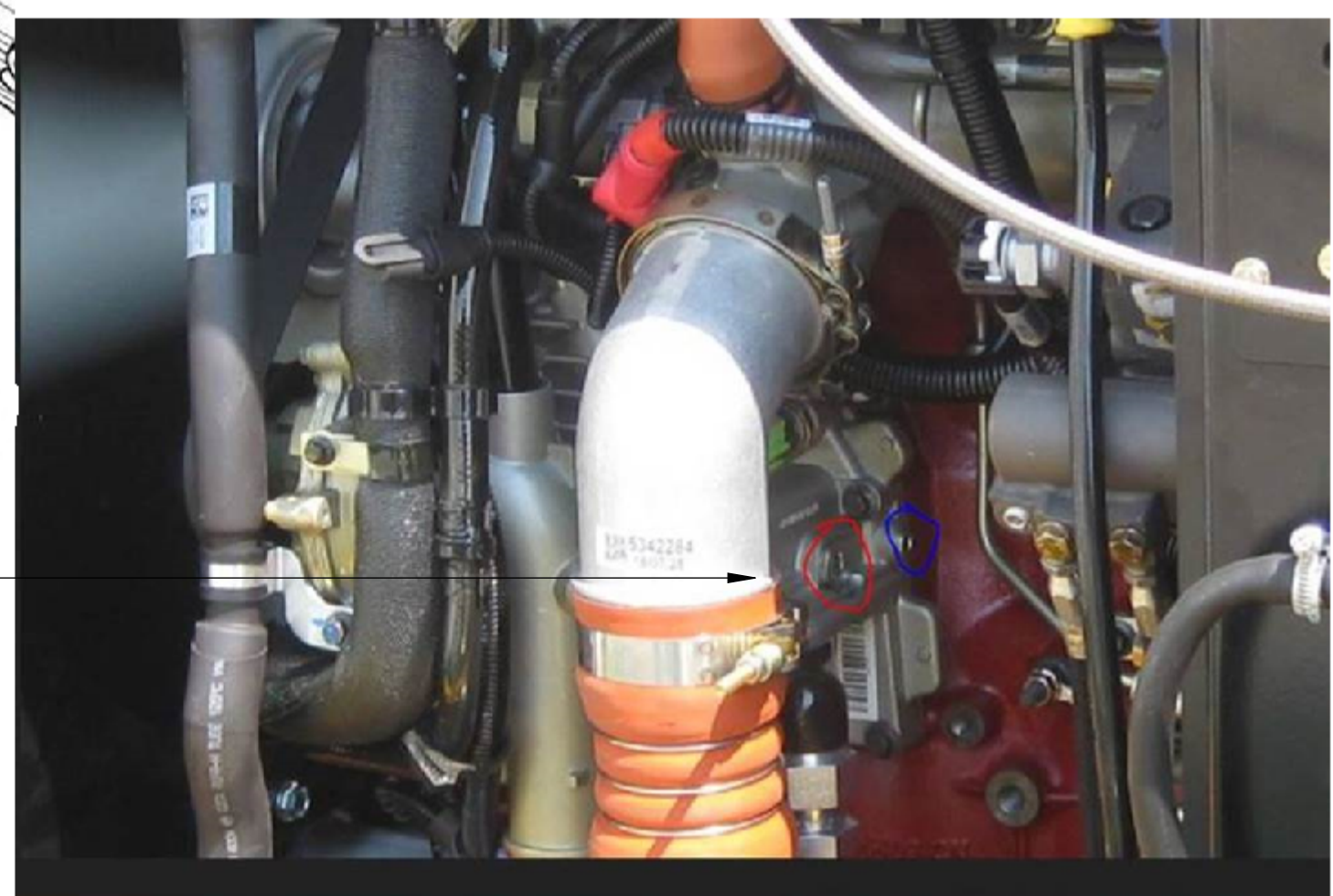

FIG. 1-1



REV	EN	DESCRIPTION	DATE	DRN
1	5422	NEW RELEASE	11-20	PR
2	5513	UPDATE INSTRUCTION AND VIEWS	1-21	PR
3	5564	UPDATE INSTRUCTION AND VIEWS	2-21	PR

DIMENSION TOLERANCES UNLESS OTHERWISE SPECIFIED			
LINEAR	.XX=±.03	.XXX=±.010	
ANGULAR	X°=±1°	X.X°=±.5°	
SURFACE FINISH NOT TO EXCEED	125 ✓	SMOOTH ALL SHARP EDGES CLEAN ALL WELDS	

THIS PRINT AND ALL INFORMATION WITHIN BELONGS TO RACINE RAILROAD PRODUCTS

RACINE RAILROAD PRODUCTS
RACINE, WISCONSIN USA

DESCRIPTION
INSTRUCTIONS, COMBO'S OIL PRESSURE SENSING

MATERIAL
SEE BOM

USED ON	793096	SCALE	1:12	DATE	11-20-20
---------	--------	-------	------	------	----------

DRN	PR	CHK	APP	JOB NO	RD190005	SHEET	1 OF 1
-----	----	-----	-----	--------	----------	-------	--------

DWG SIZE	C	CATALOG	K	DWG NO	800341
----------	---	---------	---	--------	--------

FIG. 1-2
REPLACE THE
PLACARD DB-4