

NO.	QTY	DESCRIPTION	PART NO.
1	REF	PIN, COTTER: .12 X 1	400900
2	REF	PUSHER	720134

THESE INSTRUCTIONS ARE FOR KIT 793119.

REMOVAL:

1. POWER OFF MACHINE AND TAG OUT BEFORE PERFORMING CONVERSION
2. REMOVE AND KEEP EXISTING PINS FROM PUSHERS
3. REMOVE PUSHER ASSEMBLY

INSTALLATION:

1. INSTALL BOTH PUSHERS INTO CENTER CARRIAGE
2. ATTACH WITH EXISTING CLEVIS PINS AND NEW COTTER PINS

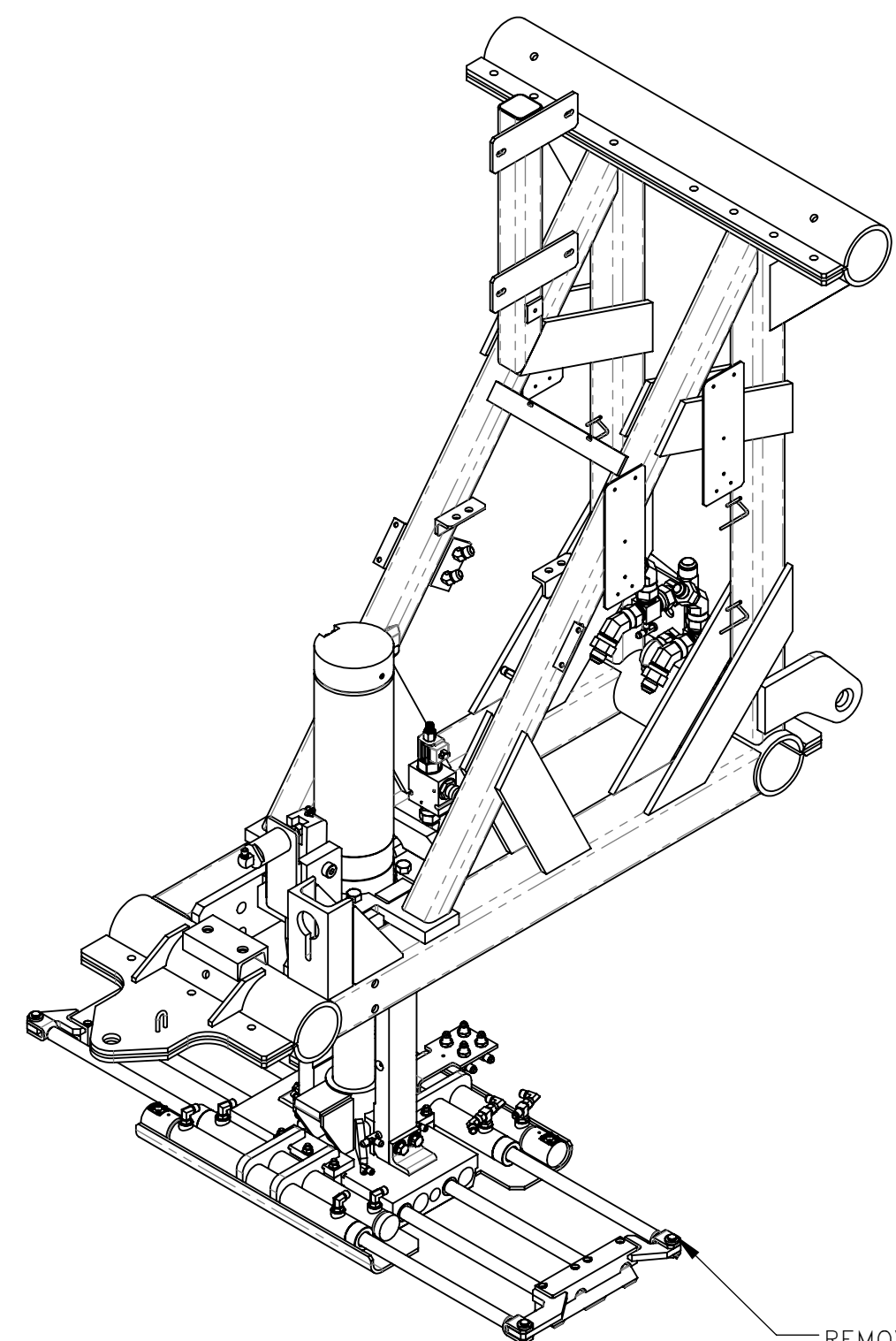

REMOVE ALL PUSHER PINS AND BOTH PUSHER

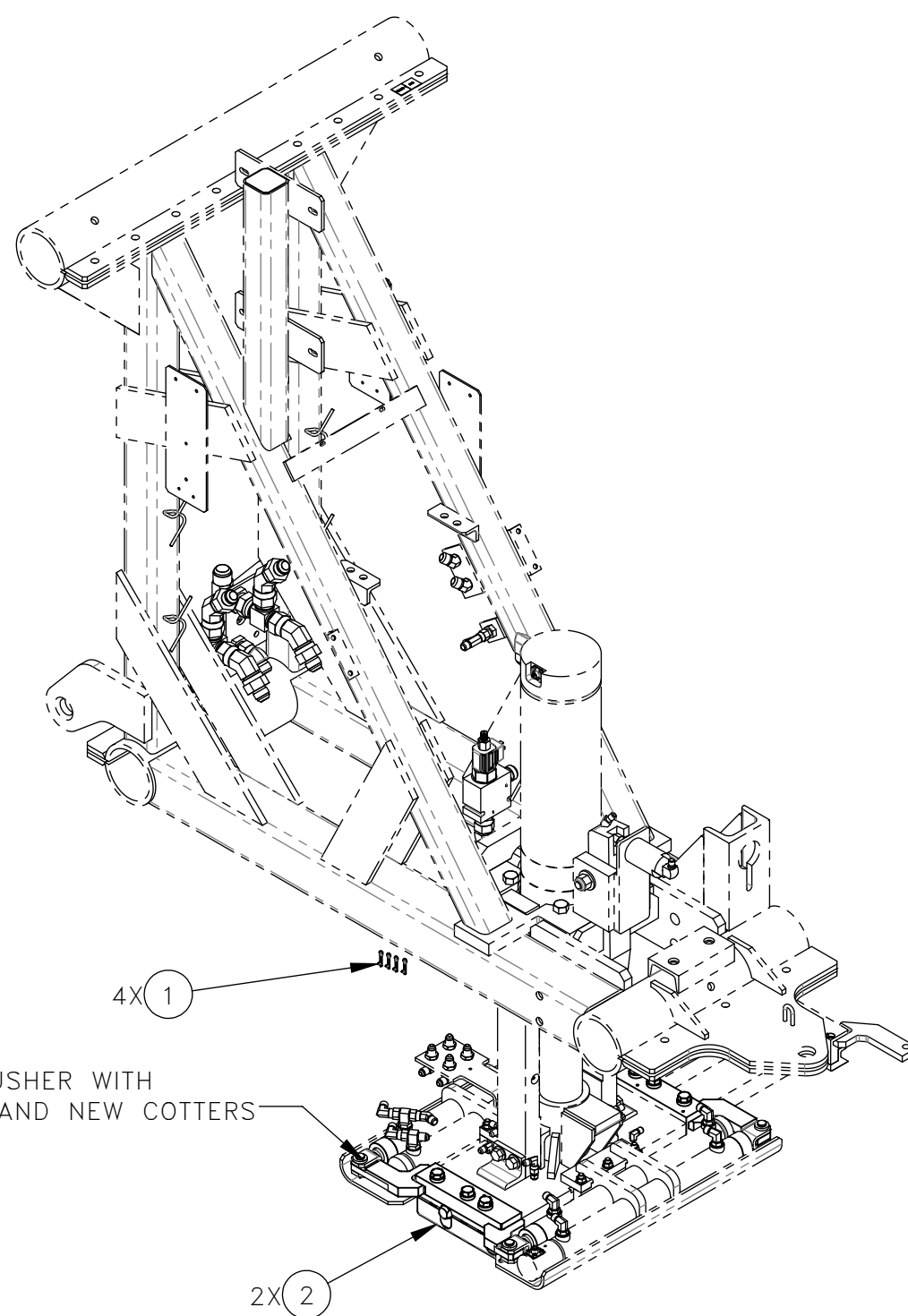

INSTALL ALL PUSHER WITH EXISTING PINS AND NEW COTTERS

REV	EN	DESCRIPTION	DATE	DRN
1	5869	NEW RELEASE	8-21	PR

DIMENSION TOLERANCES UNLESS OTHERWISE SPECIFIED

LINEAR	.XX=±.03	.XXX=±.010
ANGULAR	X°=±1°	X.X°=±.5°

SURFACE FINISH 125 ✓ NOT TO EXCEED SMOOTH ALL SHARP EDGES CLEAN ALL WELDS

THIS PRINT AND ALL INFORMATION WITHIN BELONGS TO RACINE RAILROAD PRODUCTS

RACINE RAILROAD PRODUCTS
RACINE, WISCONSIN USA

DESCRIPTION
INSTRUCTIONS, CENTER JACK PUSHER KIT

MATERIAL
SEE BOM

USED ON	793119	SCALE	4:1	DATE	08-18-21
---------	--------	-------	-----	------	----------

DRN	PR	CHK	APP	JOB NO	RD150003	SHEET	1 OF 1
-----	----	-----	-----	--------	----------	-------	--------

DWG SIZE	C	CATALOG	A	DWG NO	800358
----------	---	---------	---	--------	--------