

NO.	QTY	DESCRIPTION	PART NO.
1	1	ELBOW, 90°: #20 JIC(M) X #20 SAE(M)	463396
2	1	ADAPTER, #20 JIC(F) X #20 SAE(M)	463549
3	1	SUPPRESSOR, HYDRAULIC	472292
4	1	DECAL, NITROGEN PRECHARGE 0 PSI	477018

DUAL OIL COOLER

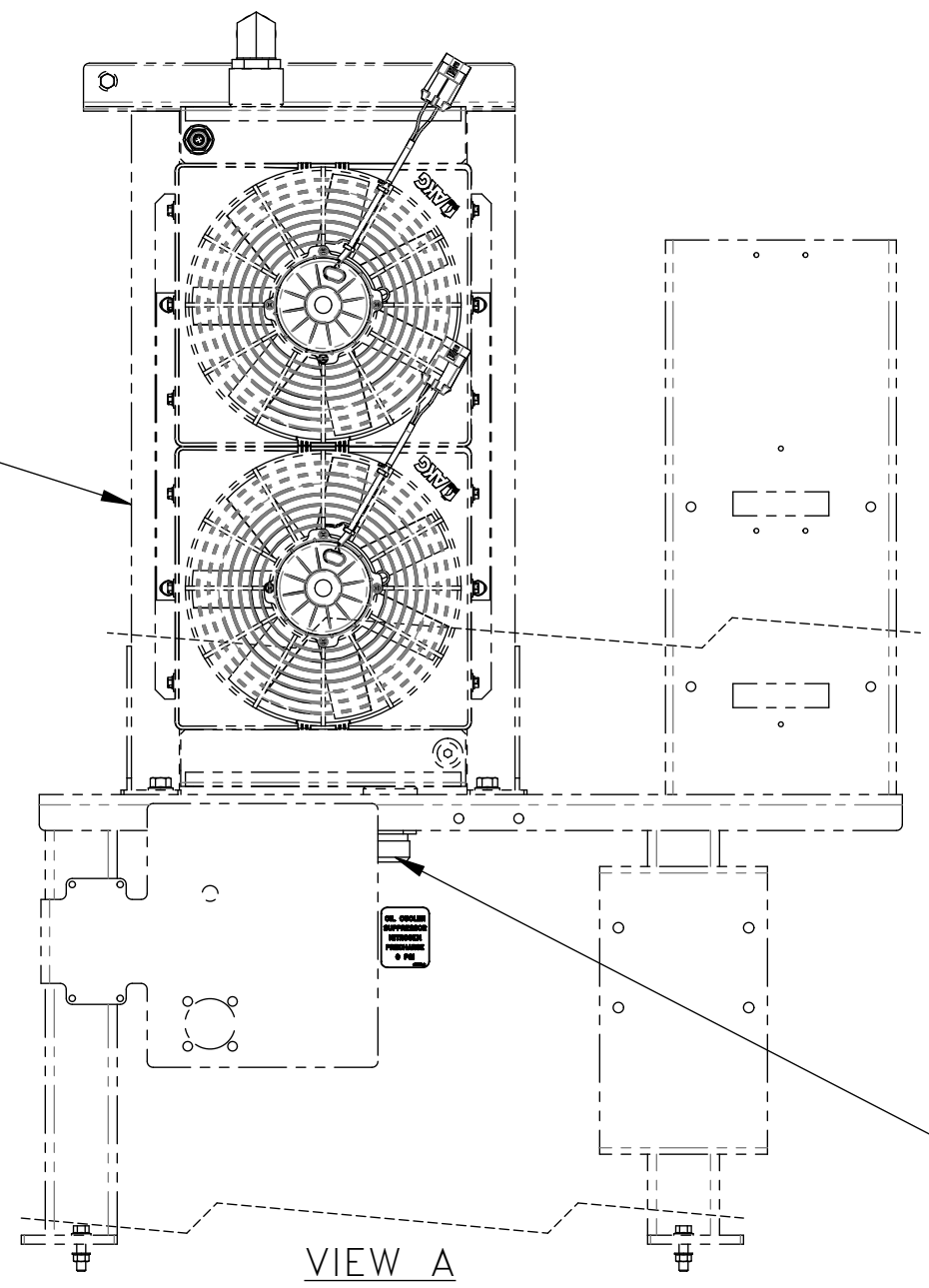

VIEW A

DISCONNECT HYD. HOSE AND ANY FITTING

THESE INSTRUCTIONS ARE FOR KIT 793136

**REMOVAL:**

1. POWER OFF MACHINE AND TAG OUT BEFORE PERFORMING CONVERSION
2. DISCONNECT HYD. HOSE AND ANY FITTING FROM THE BOTTOM OF OIL COOLER (SEE VIEW A).

**INSTALLATION:**

1. ADD ADAPTER, SUPPRESSOR AND ELBOW AS SHOWN (SEE ISO VIEW B).
2. REATTACH HYD. HOSE TO ELBOW DISCARD ANY FITTING (SEE VIEW C).
3. ADD DECAL TO THE SUPPRESSOR, PLACE TO BE SEEN. (SEE ISO VIEW B).

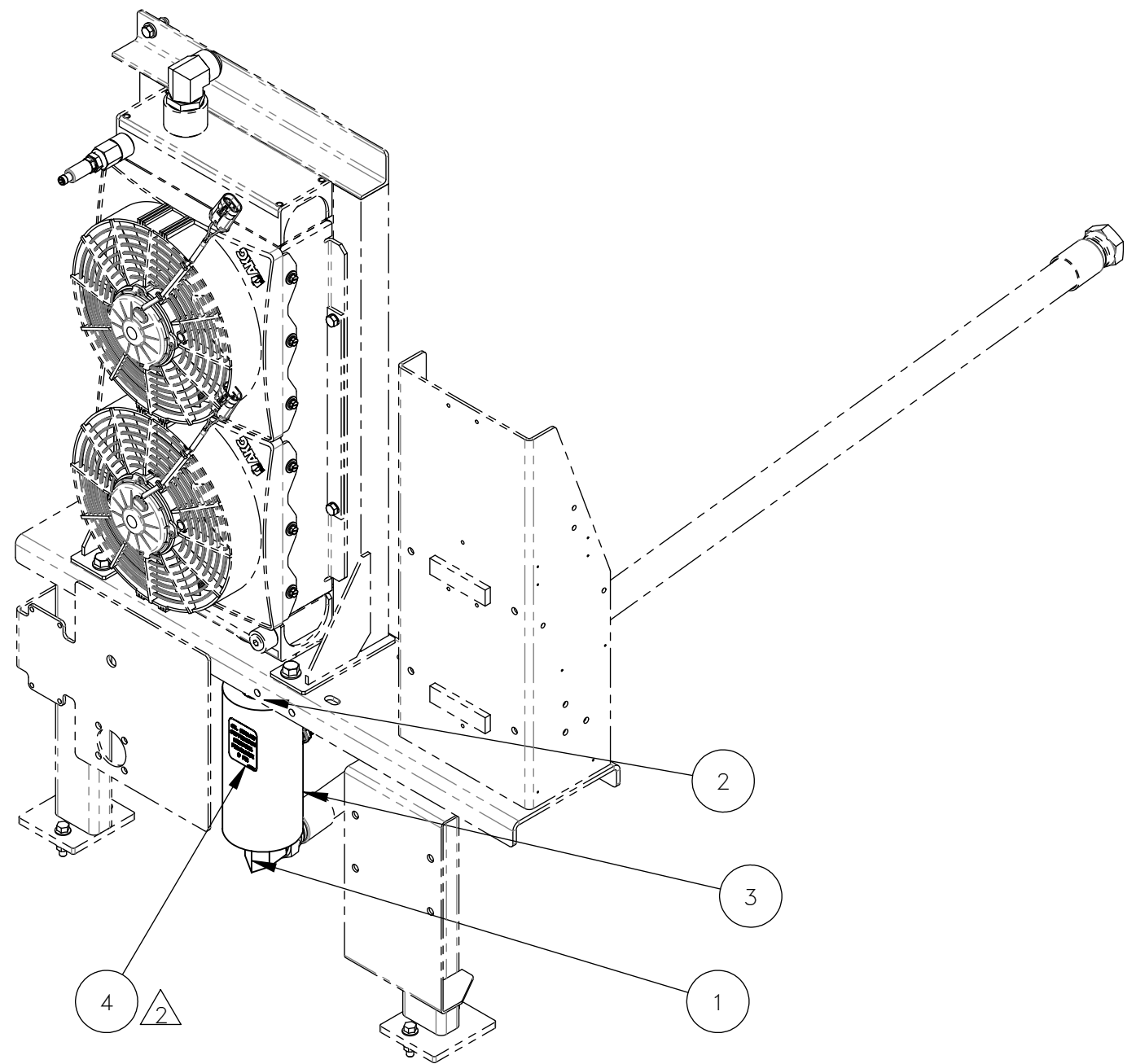

VIEW ISO B

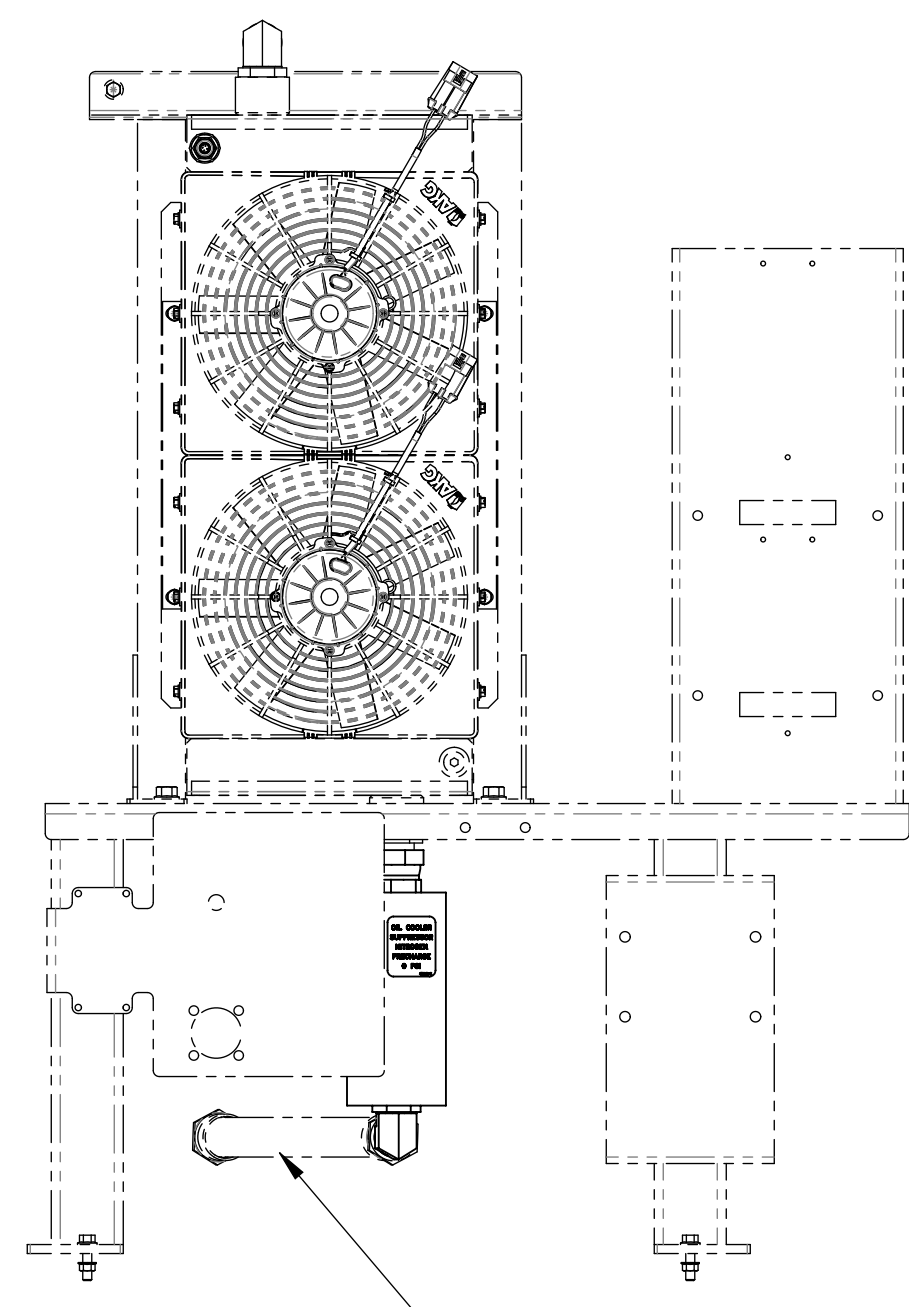

VIEW C

REV	EN	DESCRIPTION	DATE	DRN
1	6044	NEW RELEASE	01-22	PR
2	00096	SEE EN FOR DETAILS	04-23	PR

DIMENSION TOLERANCES UNLESS OTHERWISE SPECIFIED

LINEAR	.XX=±.03	.XXX=±.010	KERF ALLOW.
ANGULAR	X°=±1°	X.X°=±.5°	

SURFACE FINISH 125/ ✓ SMOOTH ALL SHARP EDGES  
NOT TO EXCEED CLEAN ALL WELDS

THIS PRINT AND ALL INFORMATION WITHIN BELONGS TO RACINE RAILROAD PRODUCTS

**RACINE RAILROAD PRODUCTS**  
RACINE, WISCONSIN USA

DESCRIPTION  
INSTRUCTIONS, COMBO OIL COOLER SUPPRESSOR KIT  
MATERIAL TYPE

USED ON	793136	SCALE	DATE
		1:8	12-21-21
DRN	WEIGHT (LBS)	JOB NO	SHEET
PR		RD190005	1 OF 1
DWG SIZE	CATALOG	DWG NO	
C	A	800382	