



Service Bulletin

Maintenance of Way Equipment

Date: 12/28/2018

RRP Service Bulletin No: RRP SB339

Title: Push Tool Replacement (RRP# 793040)

Rating:

ALERT

(Potential Problem)

INFORMATION

(Action Is Optional)

DIRECTIVE

(Action Is Required)

PRODUCT IMPROVEMENT

(Enhance Product)

Product Series: Advance Tie Plate Inserter [ATPI]

Serial No:

- ATPI-002-17
- ATPI-003-17
- ATPI-004-17
- ATPI-005-17
- ATPI-006-17
- ATPI-007-17
- ATPI-011-18
- ATPI-012-18

Summary: The previous Push Tool assembly interfered with the tie plate inserter operation. The Push Tool replacement corrects this issue.

Action: Follow the instructions on the next page to replace the Push Tool assembly.

Completion: Continue with normal machine operation after completing this procedure

Instructions

Lower the center jack plate to access the cylinders and push tools.

1. Remove the cotter pin, clevis pin and washers from each cylinder (4) places.
2. Remove the Pusher Tool Assembly (2) places.
3. Remove the screws, roll and dowel pins from the push tools to remove the wedge pushers.
4. Remove the rods from each Push Tool Assembly.
 - Return the pusher weldments to Racine Railroad Products.
 - Install the removed guide rods and wedge pusher on the new weldment.
Note: Make sure to install the roll pins and that the guide rods are not bent.
 - Apply Primer T and Loctite 242 onto each rod before installing the rods onto the supplied Push Tool weldment.
5. Disconnect the hydraulic hoses and cables from the cylinders. After disconnecting the cables from each existing cylinder, remove the hardware, guard, spacer and hydraulic cylinder.
 - Note what cables and hoses go to the left side and the right side so they can be correctly reconnected.
6. Remove the cylinder assemblies and cylinder guards. Remove the fittings from the original cylinder assemblies and install fittings on the new cylinders in a similar orientation.
 - Return the hydraulic cylinders to Racine Railroad Products.
7. Install the supplied cylinders, pushers and cotter pin in the reverse order.
 - Connect the hoses and cables to correct cylinders and verify connections before testing.

Note: During reassembly of the hydraulic cylinders onto the center jack foot, add an extension cable 1 ft to the micro-cable that connects to the right-hand center jack insert cylinder most forward.

This needs to be moved and reconnected to the forward left-hand insert cylinder that was previously not connected.
8. Install split collar onto the large hydraulic cylinder before raising assembly. It may be necessary to grind the bottom of latch plate to allow latching when assembly is raised, do not grind latch hook.



RACINE RAILROAD PRODUCTS

Racine Railroad Products
1955 Norwood Court
Mount Pleasant WI, 53403
(262) 637-9681
www.racinerailroad.com

NO.	QTY	DESCRIPTION	PART NO.
1	REF	CABLE, MICRO: 5 PIN(M) X 5 PIN(F) 90° .6 M	468270
2	REF	COLLAR, SPLIT: 3 DOUBLE	472288
3	REF	CYLINDERS, HYDR: 1.5 X 14.75	471962
4	REF	PIN, COTTER: .12 X 1	400900
5	REF	PUSHER	780834

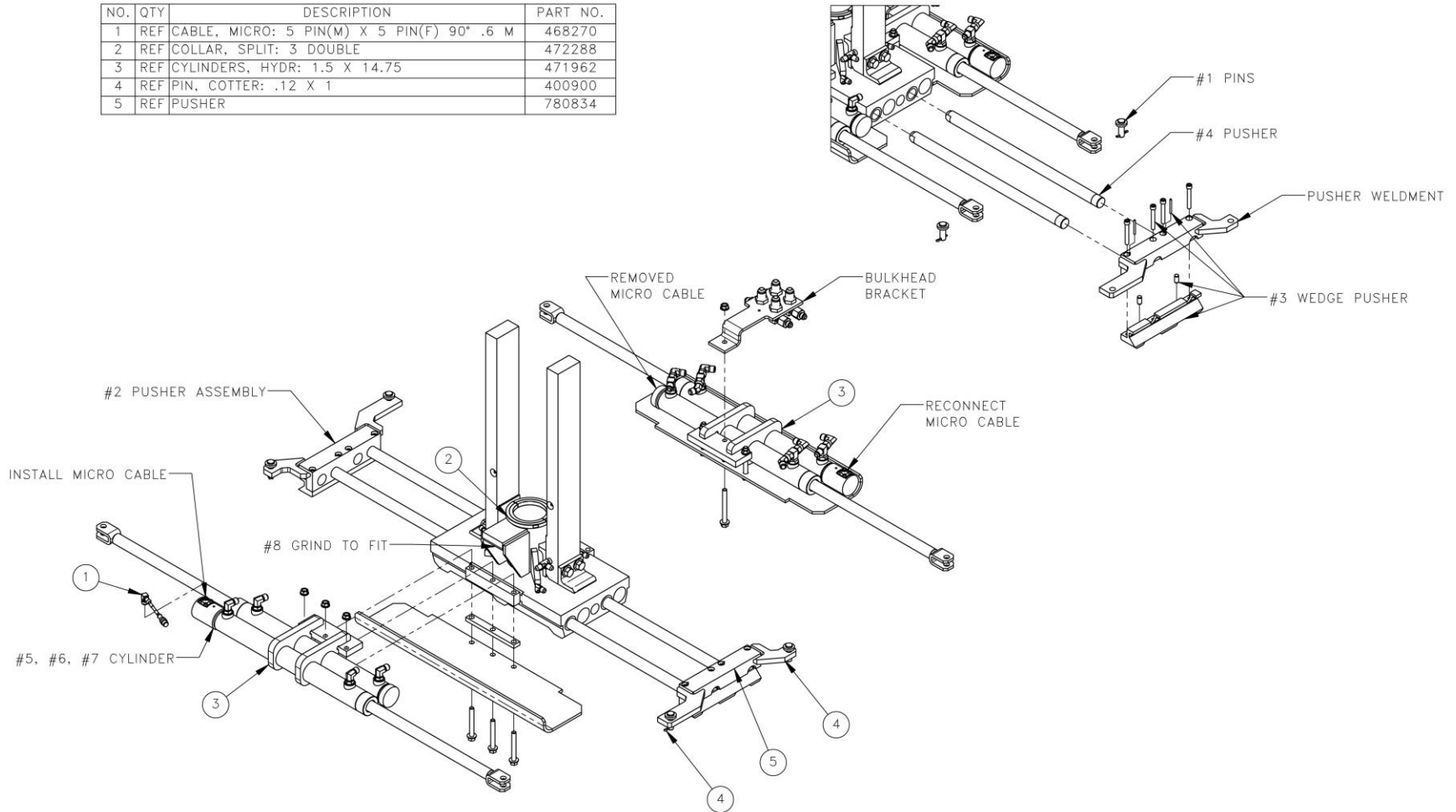



Contact: If you have any questions or we can be of any service, please contact the Racine Railroad Products service department at (262)-637-9681 or custserv@racinerailroad.com.

Safety Terms



DANGER indicates a hazardous operating procedure, practice, or condition. If the hazardous situation is not avoided death or serious injury will occur.



WARNING indicates a hazardous operating procedure, practice, or condition. If the hazardous situation is not avoided death or serious injury could occur.



CAUTION indicates a potentially hazardous operating procedure, practice, or condition. If the hazardous situation is not moderate or minor injury could occur.

Note: Indicates an essential operating procedure, practice, or condition. No personal injury is possible.