

Service Bulletin

Maintenance of Way Equipment

Date: 2.5.2021

RRP Service Bulletin No: RRP SB358

Title: Mounting Plate Kit for ATPI Center Jack Latch

Rating:

ALERT
 (Potential Problem)

INFORMATION
 (Action Is Optional)

DIRECTIVE
 (Action Is Required)

PRODUCT IMPROVEMENT
 (Enhance Product)

Product Series: Advanced Tie Plate Inserter [ATPI]

Serial No:

UPPR		
ATPI-002-17	915574	RLPI-1701
ATPI-003-17	915574	RLPI-1702
ATPI-004-17	915574	RLPI-1703
ATPI-005-17	915574	RLPI-1704
ATPI-006-17	915574	RLPI-1705
ATPI-007-17	915574	RLPI-1706
ATPI-011	915574	RLPI-1801
ATPI-012	915574	RLPI-1802
ATPI-013	915574	RLPI-1803

UPPR		
ATPI-023	931588	RLPI-1901
ATPI-024	931588	RLPI-1902
ATPI-025	931588	RLPI-1903
ATPI-026	931588	RLPI-1904

BNSF		
ATPI-014	932574	X3800191
ATPI-015	932574	X3800192
ATPI-016	932574	X3800193
ATPI-017	932574	X3800194

OTHER	
ATPI-001-16	915575
ATPI-018	930587

Summary: The center jack foot does not lower enough.

Action: Follow the instructions on page 3.

Completion / Resolution:

Continue with normal machine operation after installing the center jack mounting plate spacers.

If you have any questions or we can be of any service, please contact the Racine Railroad Products Service Department at (262)-637-9681.

KIT, MOUNTING PLATE / RRP# 793089 [Rev 3 (2.2021)]

NO.	QTY	DESCRIPTION	PART NO.
1	4	PLATE, MOUNTING	321676
2	1	LATCH	322179
3	4	SCR, HEX: .62-11 X 3.5	400765
4	4	NUT, HEX ES: .62-11 HVY	405325
5	1	INSTRUCTIONS, CENTER JACK SPACER KIT	800339

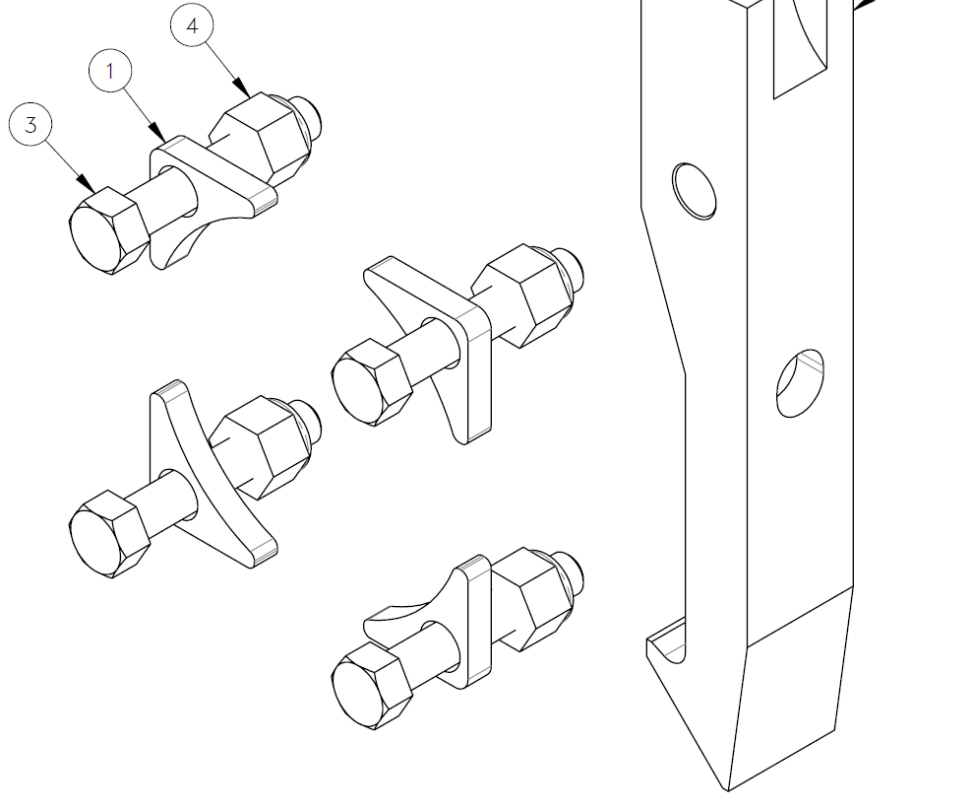

Instructions

1. Adjust the machine workhead to Maintenance Mode.
2. Unlock and lower the center jack.
3. Remove split collar 472288 (see Detail B).
4. Remove the center jack cylinder four bolt assemblies (see Detail B).
5. Replace bolt and spacer assemblies with kit supplied spacers and fasteners. Items 1, 3 & 4 (see Detail B).
6. Replace existing latch with new latch 322179 (supplied).

Note: If the center jack does not lock properly, please contact RRP Field Service.

