

Service Bulletin

Maintenance of Way Equipment

Date: 3.25.2021

RRP Service Bulletin No: RRP SB366

Title: Vent Valve on Graco Grease Pump Installation

Rating:



ALERT
(Potential Problem)



INFORMATION
(Action Is Optional)



DIRECTIVE
(Action Is Required)



PRODUCT IMPROVEMENT
(Enhance Product)

Product Series: Advanced Tie Plate Inserter [ATPI]

Serial No:

ATPI-036	933588	CP	5014.21
APT-037	933588	CP	5014-22
ATPI-038	933588	CP	5014-23

APT-032	933588	CP	7014-14
ATPI-035	933588	CP	5014--20

ATPI-019	935588	CN-W	CN43865
ATPI-020	935588	CN-W	CN43866
ATPI-030	935588	CN-W	CN43867
ATPI-031	935588	CN-W	CN43868

ATPI-021	945588	CN-S	CN43863
ATPI-022	945588	CN-S	CN43864

ATPI-023	931588	UPRR	RLPI-1901
ATPI-024	931588	UPRR	RLPI-1902
ATPI-025	931588	UPRR	RLPI-1903
ATPI-026	931588	UPRR	RLPI-1904

Summary: Install Lube Remote kit#793110 to add missing vent valve for proper functionality of the grease pump.

Action: See Instructions on the next pages for installing Lube Remote Kit.

Completion / Resolution: Continue with normal machine operation after installation.

Contact: If you have any questions or we can be of any service, please contact the Racine Railroad Products Service Department at (262)-637-9681 or fieldservice@racinerailroad.com.

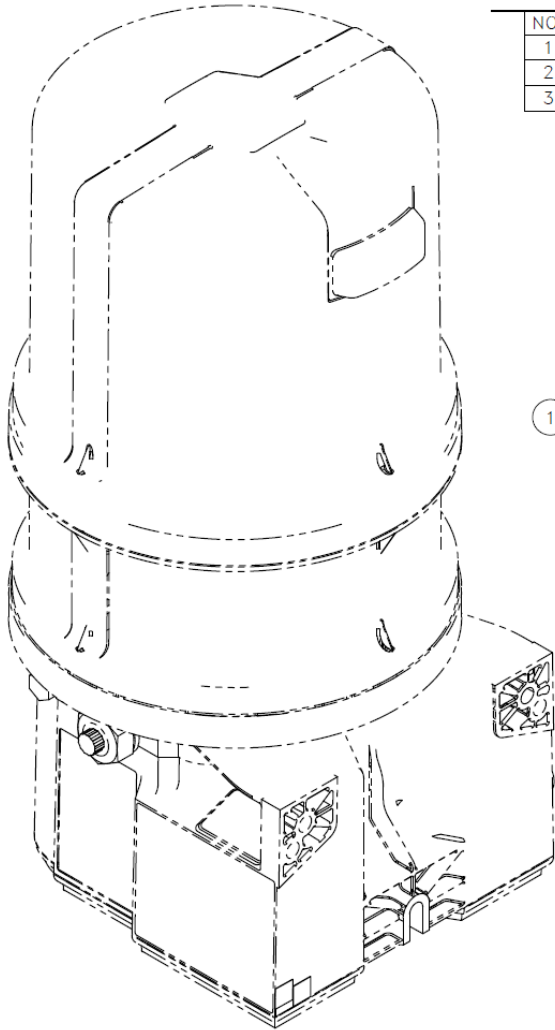

NO.	QTY	DESCRIPTION	PART NO.
1	1	VALVE, VENT	475734
2	1	WIRE HARNESS, GRACO DC POWER	719722
3	1	INSTRUCTIONS, LUBE REMOTE KIT	800350

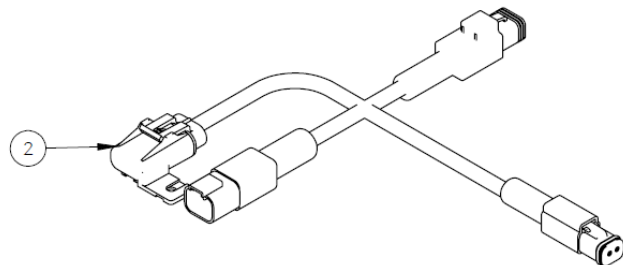
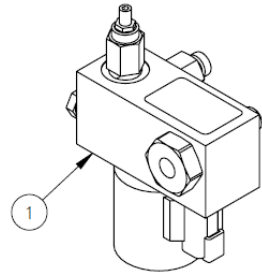

NO.	QTY	DESCRIPTION	PART NO.
1	REF	VALVE, VENT	475734
2	REF	WIRE HARNESS, GRACO DC POWER	719722

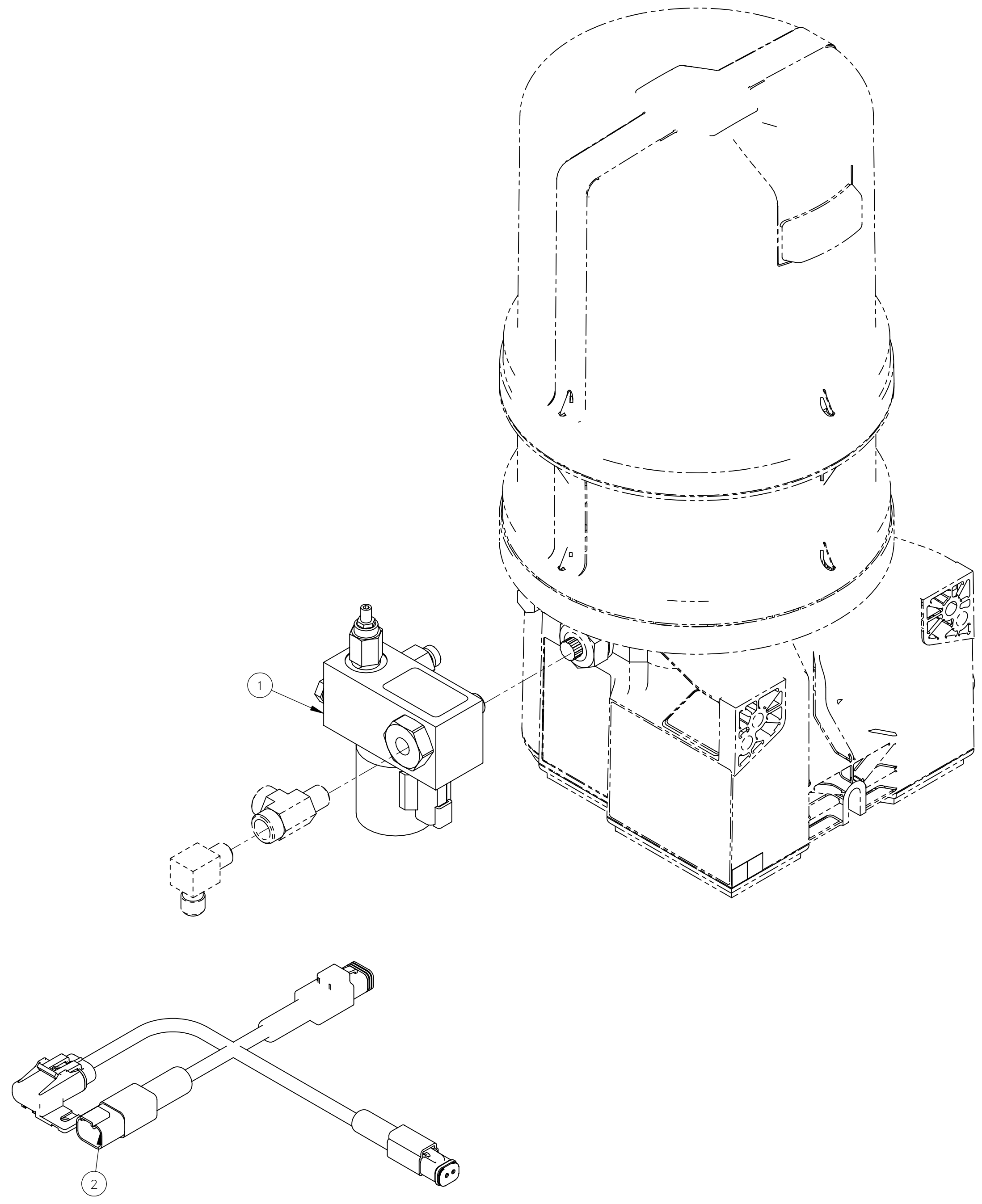

REV	EN	DESCRIPTION	DATE	DRN
1	5582	NEW RELEASE	3-21	ASM

DIMENSION TOLERANCES UNLESS OTHERWISE SPECIFIED

LINEAR	.XX=±.03	.XXX=±.010
ANGULAR	X°=±1°	X.X°=±.5°

SURFACE FINISH 125 ✓ SMOOTH ALL SHARP EDGES
NOT TO EXCEED CLEAN ALL WELDS

THIS PRINT AND ALL INFORMATION WITHIN
BELONGS TO RACINE RAILROAD PRODUCTS

RACINE RAILROAD PRODUCTS
RACINE, WISCONSIN USA

DESCRIPTION
INSTRUCTIONS, LUBE REMOTE KIT

MATERIAL
SEE BOM

USED ON	SCALE	DATE
793110	1:2	03-08-21

DRN	CHK	APP	JOB NO	SHEET
ASM			RD150003	1 OF 6

DWG SIZE	CATALOG	DWG NO
C	K	800350

Instructions for Installing Vent Valve to Grease Pump

Step1: Installing the vent valve to grease pump

Installation

Pressure Relief

Relieve pressure in system by using two wrenches working in opposite directions on pump element and pump element fitting to **only** loosen fitting.

NOTE: When loosening pump element fitting, do NOT loosen pump element. Loosening pump element will change the output volume.

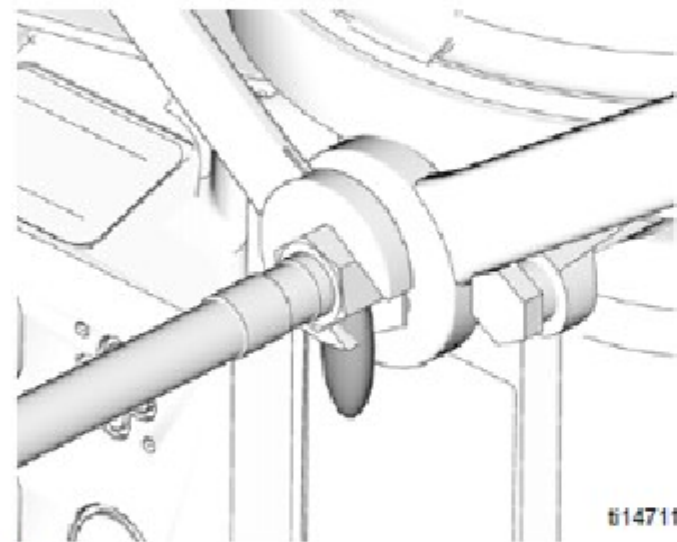
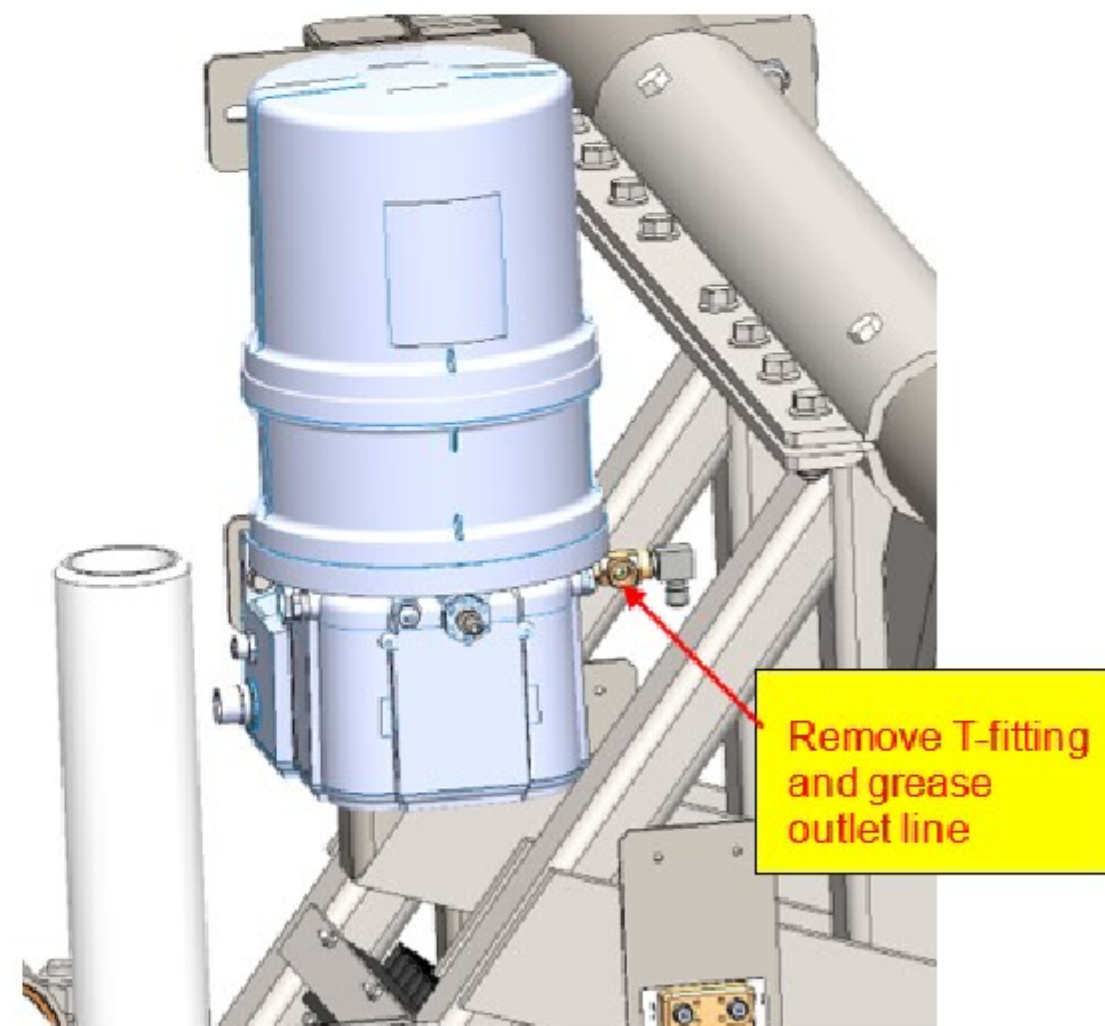
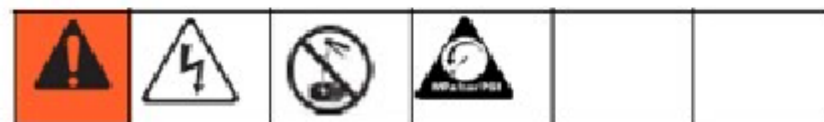

FIG. 1

*Before proceeding with installation of vent valve, disconnect the tee fitting and grease outlet line from pump (see below)



Vent Valve Installation



Reference numbers used in these instructions correspond to parts included in Kit and are provided on page 6. Parts identified with an alpha character are user provided or already installed components.

1. Disconnect power source.
2. If unit has already been in service, relieve pressure.

3. Be sure the two o-rings (8, 9) are correctly installed on the bolt (7) as shown in FIG. 2.

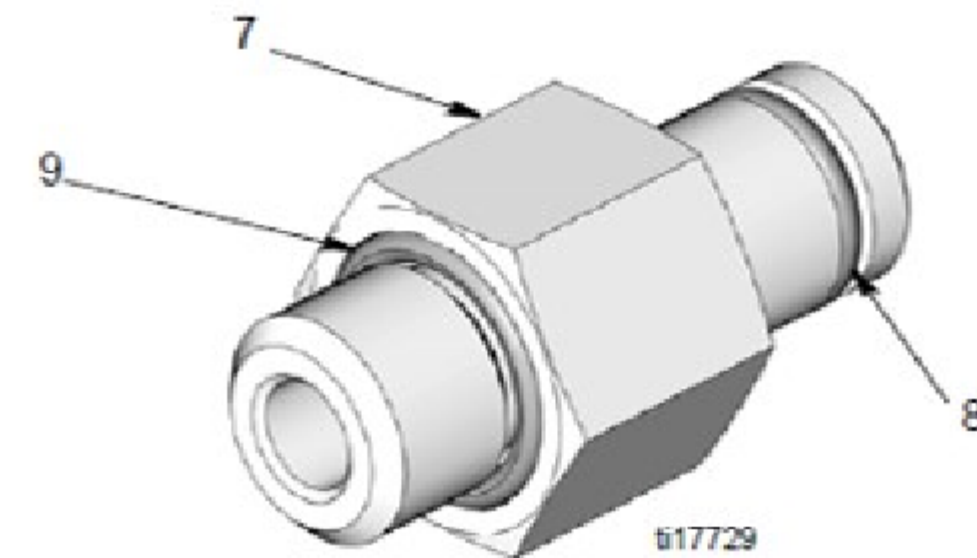

FIG. 2

4. Remove plug from G3 and install vent valve alignment bolt (7) in it's place as shown in FIG. 3. Torque to 30 in. lbs. (0.2 N.m).

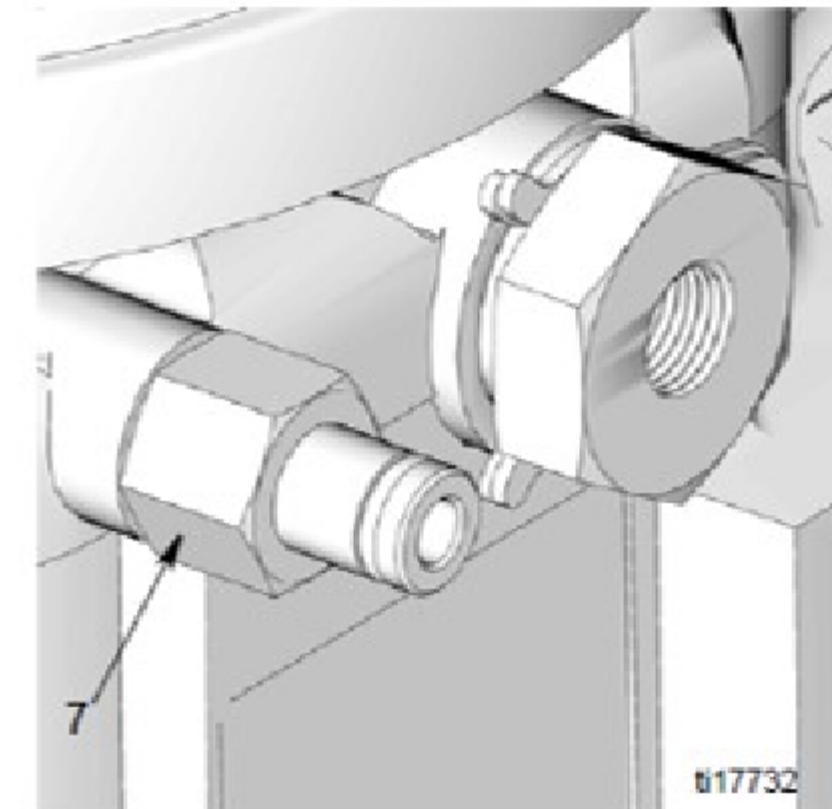

FIG. 3

REV	EN	DESCRIPTION	DATE	DRN
1	5582	NEW RELEASE	3-21	ASM
DIMENSION TOLERANCES UNLESS OTHERWISE SPECIFIED				
LINEAR	.XX=±.03	.XXX=±.010		
ANGULAR	X°=±1°	X.X°=±.5°		
SURFACE FINISH NOT TO EXCEED	125 ✓	SMOOTH ALL SHARP EDGES CLEAN ALL WELDS		
THIS PRINT AND ALL INFORMATION WITHIN BELONGS TO RACINE RAILROAD PRODUCTS				
RACINE RAILROAD PRODUCTS RACINE, WISCONSIN USA				
DESCRIPTION INSTRUCTIONS, LUBE REMOTE KIT				
MATERIAL SEE BOM				
USED ON	793110	SCALE	DATE	
		1:6	03-08-21	
DRN	CHK	APP	JOB NO	SHEET
ASM			RD150003	2 OF 6
DWG SIZE	CATALOG	DWG NO		
C	K	800350		

5. Grease o-ring (6) and install in block opening (1a) as shown in FIG. 4.

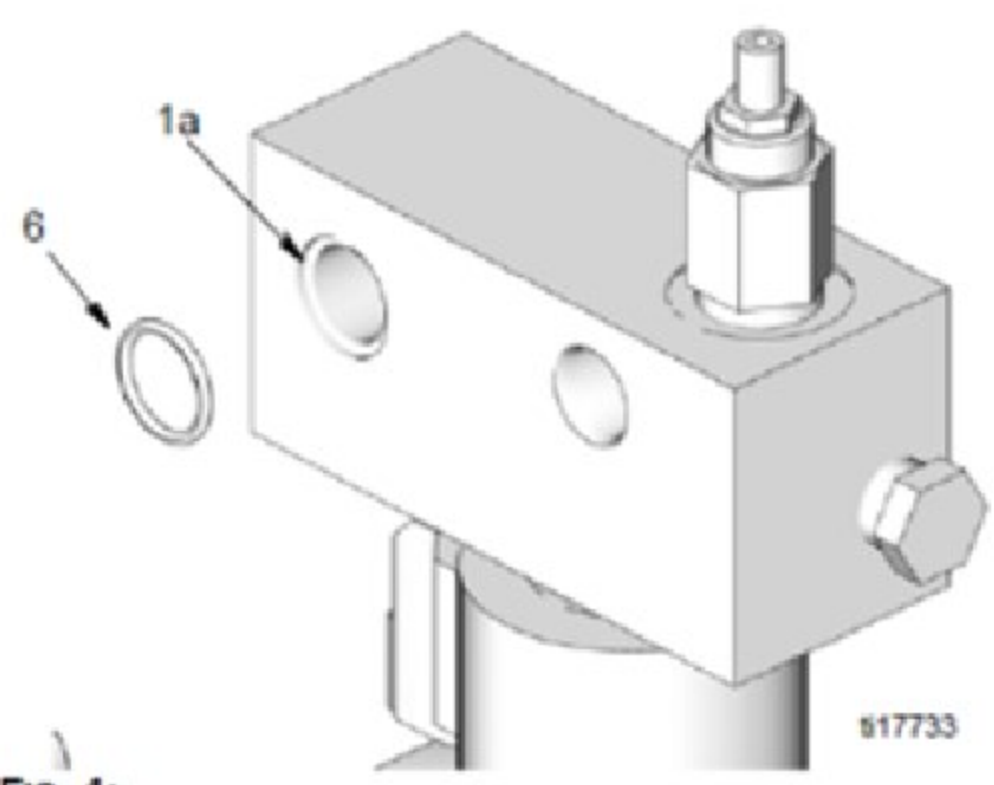

FIG. 4:

- 6. Be sure o-ring (5) is installed on bolt (4) as shown in FIG. 5.
- 7. Install vent valve mounting bolt (4) through hole (1b) in block (1) and into G3 pump (FIG. 5). Tighten mounting bolt (4) securely then torque to 35 ft. lbs. (47.45 N.m).

NOTE: System connection is made through primary outlet (4a).

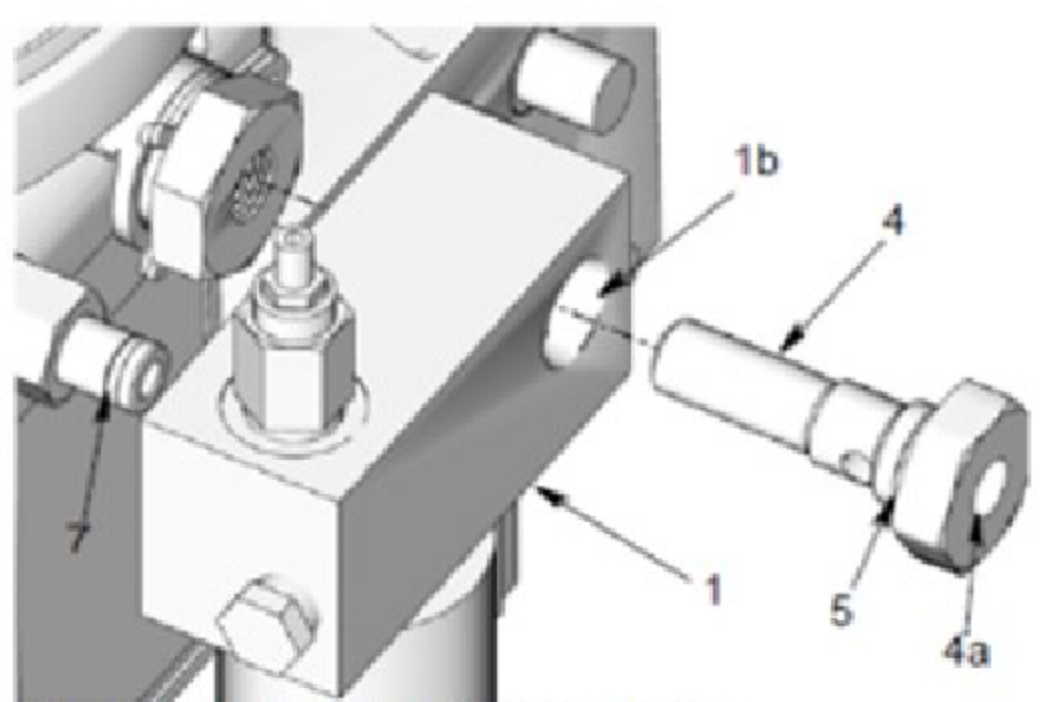

FIG. 5: Right Side Installation Shown

8. Plug (10) can be removed to install a pressure gauge or to use this port as an outlet.

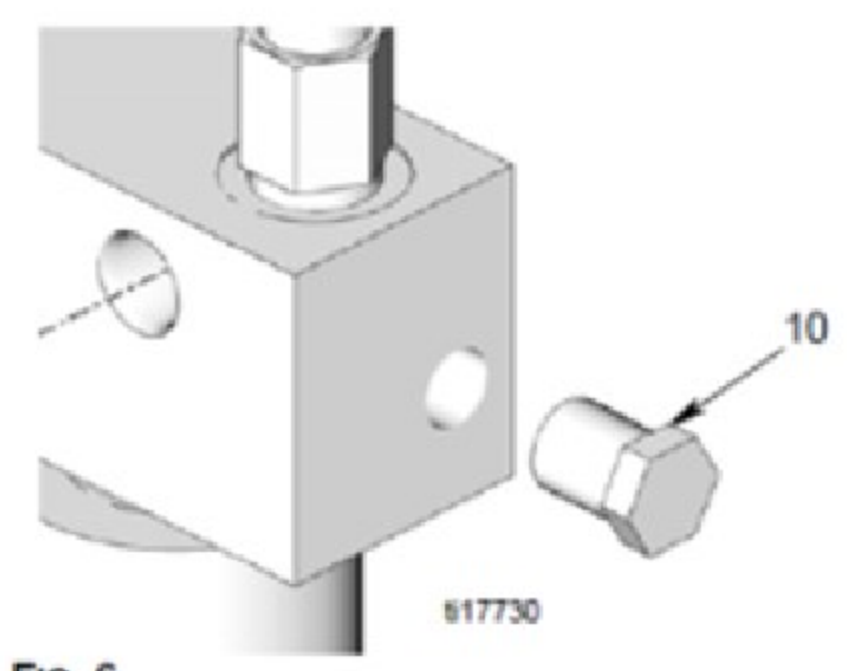

FIG. 6

Step 9 applies to models 571169, 571170, 571171, 571172 only. All other models skip this step and continue instructions with Step 10.

9. Connect end of cable (13) to the G3 (FIG. 7).

NOTE: To verify the correct port on the G3 is selected, locate the symbol shown in FIG. 7 on the G3 label.

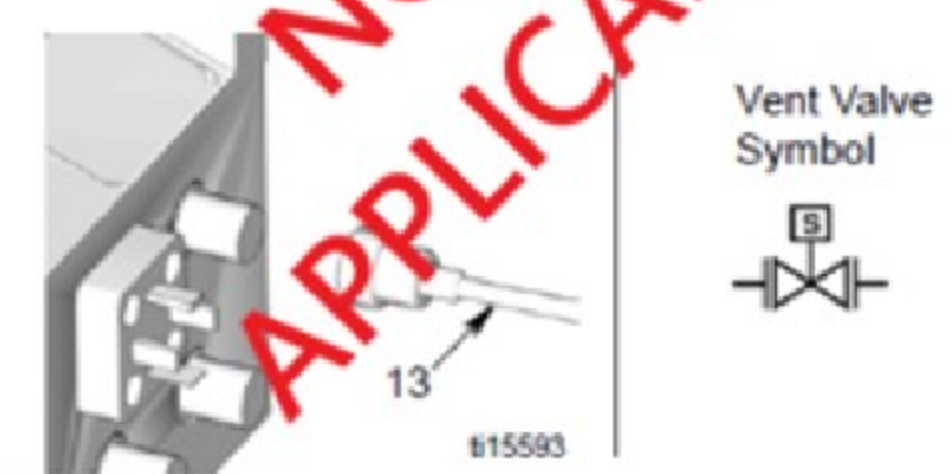
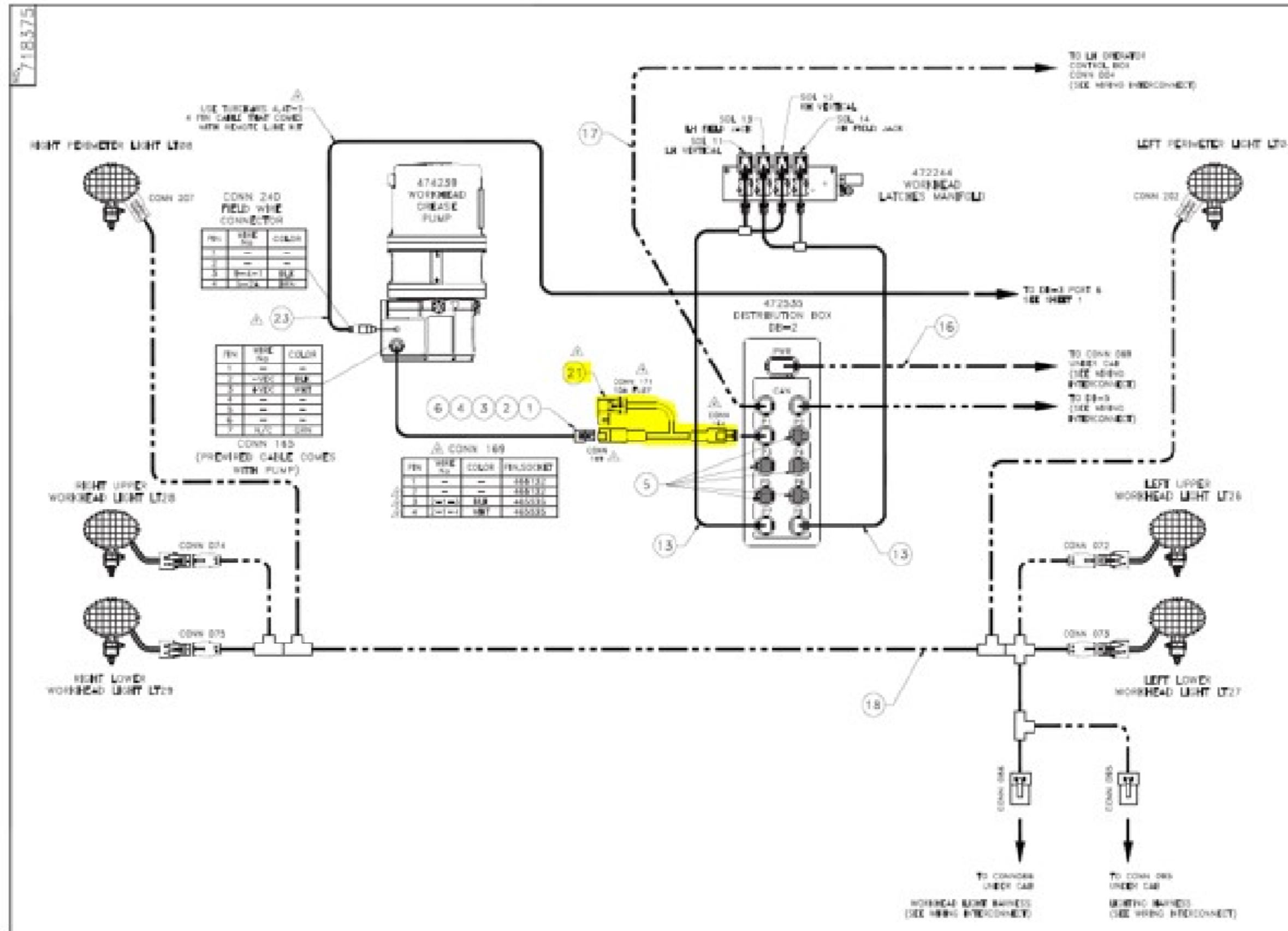

FIG. 7

REV	EN	DESCRIPTION	DATE	DRN
1	5582	NEW RELEASE	3-21	ASM
DIMENSION TOLERANCES UNLESS OTHERWISE SPECIFIED				
LINEAR		.XX=±.03	.XXX=±.010	
ANGULAR		X°=±1°	X.X°=±.5°	
SURFACE FINISH NOT TO EXCEED		125 ✓	SMOOTH ALL SHARP EDGES CLEAN ALL WELDS	
THIS PRINT AND ALL INFORMATION WITHIN BELONGS TO RACINE RAILROAD PRODUCTS				
RACINE RAILROAD PRODUCTS RACINE, WISCONSIN USA				
DESCRIPTION				
INSTRUCTIONS, LUBE REMOTE KIT				
MATERIAL				
SEE BOM				
USED ON		793110	SCALE	DATE
			1:6	03-08-21
DRN	CHK	APP	JOB NO	SHEET
ASM			RD150003	3 OF 6
DWG SIZE	CATALOG	DWG NO		
C	K	800350		

Step2: Replacing current harness with new harness (supplied)

Remove existing harness currently wired to DB2 and grease pump (item 21, highlighted in yellow below)



Replace/connect with new harness supplied (RRP#719722) as shown below:

REV	EN	DESCRIPTION	DATE	DRN
1	5582	NEW RELEASE	3-21	ASM
DIMENSION TOLERANCES UNLESS OTHERWISE SPECIFIED				
LINEAR	.XX=±.03	.XXX=±.010		
ANGULAR	X°=±1°	X.X°=±.5°		
SURFACE FINISH NOT TO EXCEED	125 ✓	SMOOTH ALL SHARP EDGES CLEAN ALL WELDS		
THIS PRINT AND ALL INFORMATION WITHIN BELONGS TO RACINE RAILROAD PRODUCTS				
RACINE RAILROAD PRODUCTS RACINE, WISCONSIN USA				
DESCRIPTION INSTRUCTIONS, LUBE REMOTE KIT				
MATERIAL SEE BOM				
USED ON	793110	SCALE	1:6	DATE
				03-08-21
DRN	ASM	CHK	APP	JOB NO
				RD150003
				SHEET
				4 OF 6
DWG SIZE	C	CATALOG	K	DWG NO
				800350

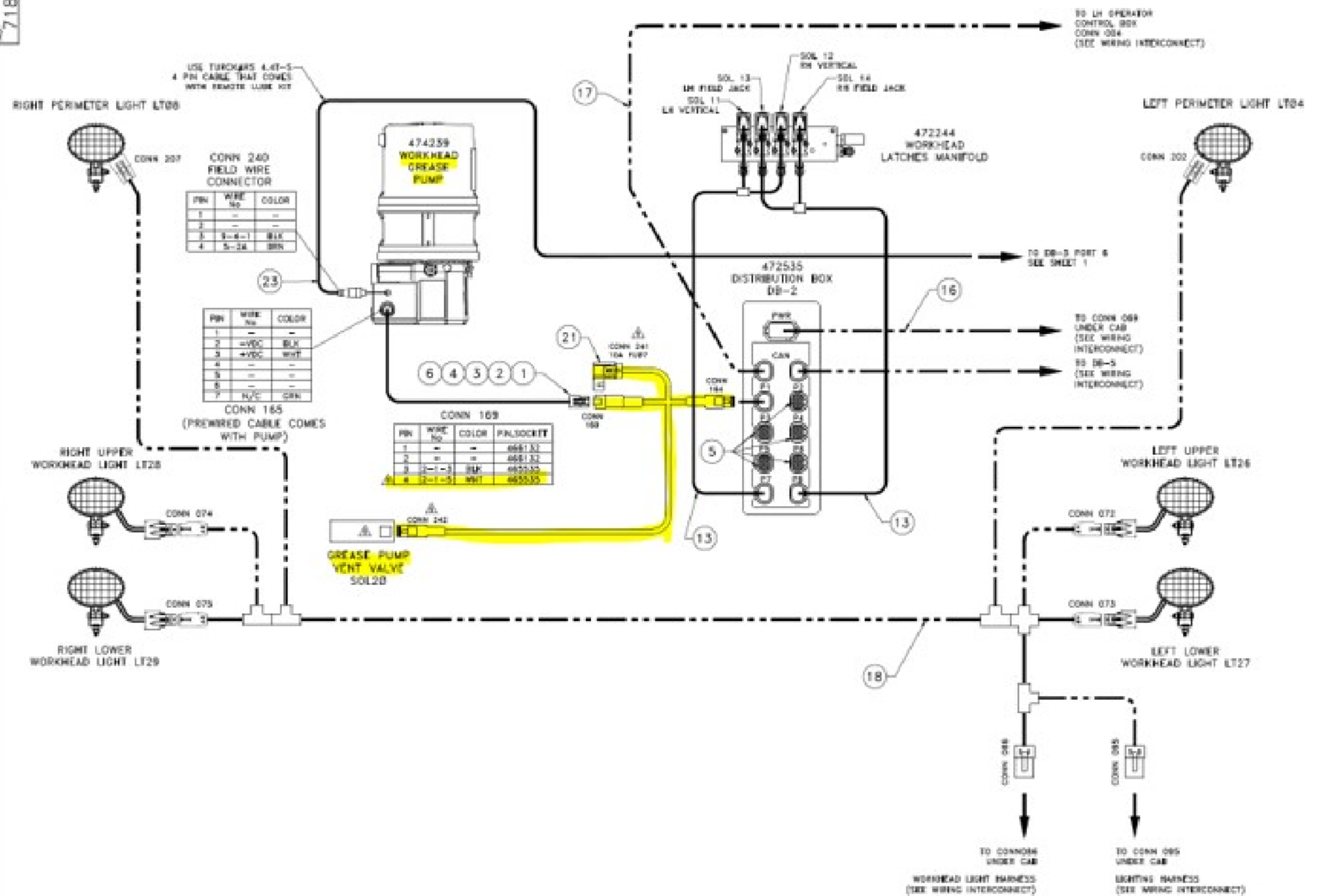

REV	EN	DESCRIPTION	DATE	DRN
1	5582	NEW RELEASE	3-21	ASM

DIMENSION TOLERANCES UNLESS OTHERWISE SPECIFIED			
LINEAR	.XX=±.03	.XXX=±.010	
ANGULAR	X°=±1°	X.X°=±.5°	

SURFACE FINISH 125 ✓ SMOOTH ALL SHARP EDGES
NOT TO EXCEED ✓ CLEAN ALL WELDS

THIS PRINT AND ALL INFORMATION WITHIN
BELONGS TO RACINE RAILROAD PRODUCTS

RACINE RAILROAD PRODUCTS
RACINE, WISCONSIN USA

DESCRIPTION
INSTRUCTIONS, LUBE REMOTE KIT

MATERIAL
SEE BOM

USED ON 793110 SCALE 1:6 DATE 03-08-21

DRN ASM CHK APP JOB NO RD150003 SHEET 5 OF 6

DWG SIZE C CATALOG K DWG NO 800350

Step3: Re-install the T-fitting and the grease outlet line (removed in step 1) onto outlet element on vent valve (as shown below)

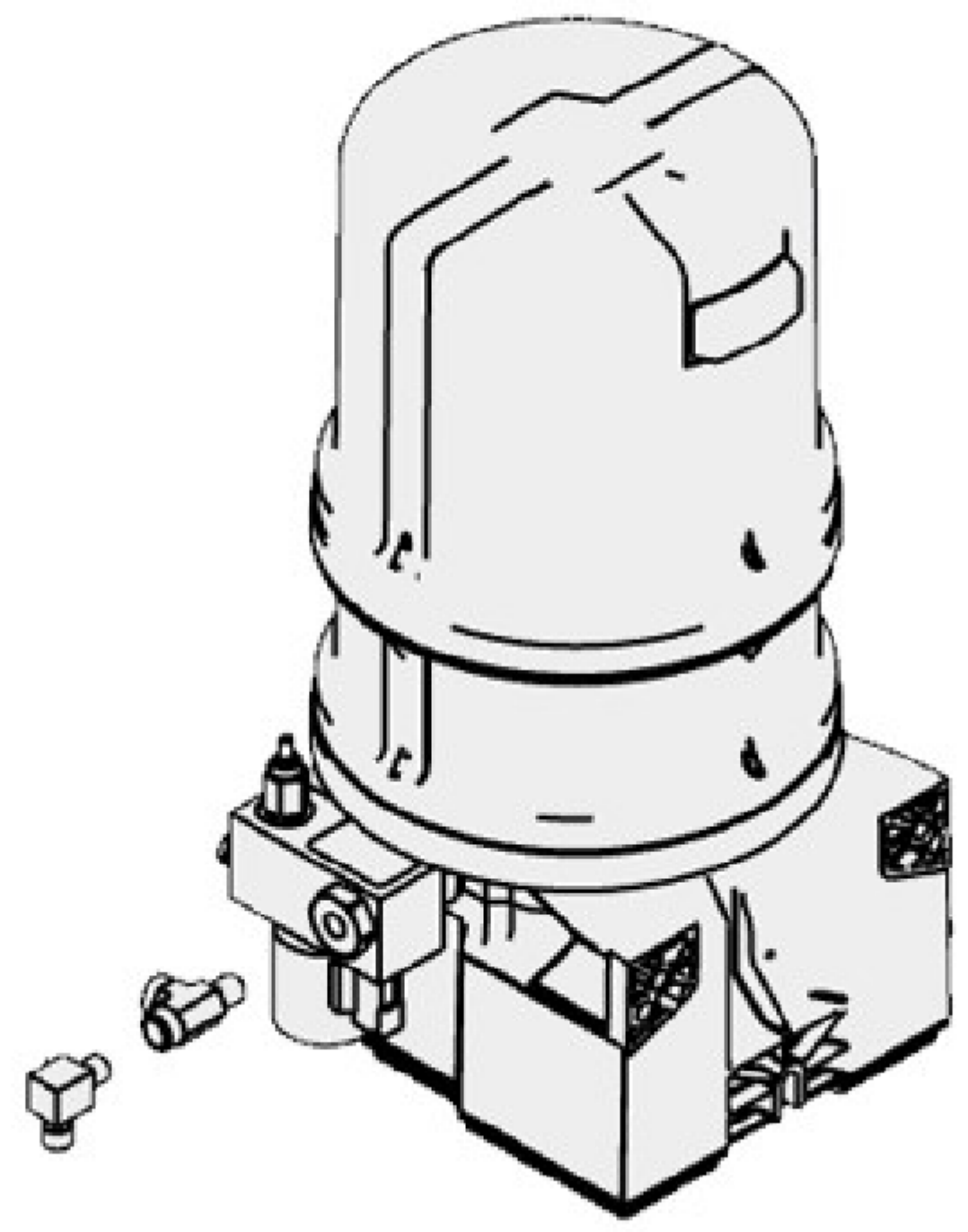

REV	EN	DESCRIPTION	DATE	DRN
1	5582	NEW RELEASE	3-21	ASM
DIMENSION TOLERANCES UNLESS OTHERWISE SPECIFIED				
LINEAR	.XX=±.03	.XXX=±.010		
ANGULAR	X°=±1°	X.X°=±.5°		
SURFACE FINISH NOT TO EXCEED	125 ✓	SMOOTH ALL SHARP EDGES CLEAN ALL WELDS		
THIS PRINT AND ALL INFORMATION WITHIN BELONGS TO RACINE RAILROAD PRODUCTS				
RACINE RAILROAD PRODUCTS RACINE, WISCONSIN USA				
DESCRIPTION				
INSTRUCTIONS, LUBE REMOTE KIT				
MATERIAL				
SEE BOM				
USED ON	793110	SCALE	DATE	
		1:6	03-08-21	
DRN	CHK	APP	JOB NO	SHEET
ASM			RD150003	6 OF 6
DWG SIZE	CATALOG	DWG NO		
C	K	800350		